



DEPARTMENT OF THE ARMY
US ARMY CORPS OF ENGINEERS
NEW ENGLAND DISTRICT
696 VIRGINIA ROAD
CONCORD MA 01742-2751

November 23, 2015

Regulatory Division
CENAE-R-PEC
Permit Number: NAE-2015-01929

City of Portsmouth
c/o Terry Desmarais
680 Peverly Hill Road
Portsmouth, New Hampshire 03801

Dear Applicant:

This is to inform you that we have reviewed your application to conduct activities as described on the attached NH State Permit 2015-01878, dated October 9, 2015.

Based on the information you provided to the New Hampshire Wetlands Bureau, we have determined that your project, which includes a discharge of dredged or fill material into waters or wetlands, will have only minimal individual or cumulative environmental impacts on waters of the United States, including wetlands. **We hereby conditionally authorize your project under the attached Federal permit known as the New Hampshire State Programmatic General Permit (NHSPGP) pending final concurrence with the Wetlands Bureau approval by the Governor & Executive Council (G&C).** This work must be performed in accordance with the terms and conditions of the PGP including the following Special Conditions:

Special Condition 1: As described in the attached New Hampshire Division of Historical Resources letter dated May 27, 2015 fencing and monitoring by an archaeologist will be conducted in Areas 5 and 6 to protect two identified middens and a probable remnant of the Fort Washington earthworks.

Special Condition 2: This authorization is for the revetment work shown in the attached plans and referenced in the attached State Permit. Inland wetland impacts and other associated work is not authorized under this authorization.

Special Condition 3: All fill activities below the High Tide Line shall be conducted during low tide to reduce potential impacts to the Atlantic Sturgeon.

This authorization expires on August 3, 2017 unless the PGP is modified, suspended, or revoked before that. You must complete the work authorized herein by that date. If you do not, you must contact this office to determine the need for further authorization before continuing the activity. We recommend that you contact us *before* this authorization expires to discuss a time extension or reissuance of the authorization.

If you change the plans or construction methods for work within our jurisdiction, please contact us immediately to discuss modification of this authorization. This office must approve any changes before you undertake them.

This authorization presumes that the work as described above and as shown on your plans noted above is in waters of the U.S. Should you desire to appeal our jurisdiction, please submit a request for an approved jurisdictional determination in writing to this office.

This permit does not obviate the need to obtain other Federal, state or local authorizations required by law, including those listed in the PGP. Performing work not specifically authorized by this determination or failing to comply with all the terms and conditions of the PGP may subject you to the enforcement provisions of Corps regulations.

We continually strive to improve our customer service. In order for us to better serve you, we would appreciate your completing our Customer Service Survey located at http://www.nae.usace.army.mil/reg/Customer_Service_Survey.pdf.

If you have questions concerning this, please contact Richard Kristoff of my staff at (978) 318-8171, (978) 318-8335/8338, (800) 343-4789, or, if calling from within Massachusetts, (800) 362-4367.

Sincerely,

Frank J. DelGiudice
Chief, Permits & Enforcement Branch
Regulatory Division

Enclosures

Copies Furnished:

New Hampshire Department of Environmental Services, Wetlands Bureau, Attn: Mr. Collis Adams, P.O. Box 95, 29 Hazen Drive, Concord, New Hampshire 03302-0095

Jon Pearson, AECOM, 701 Edgewater Drive, Wakefield, Massachusetts 01880,
Jon.Pearson@aecom.com



The State of New Hampshire
DEPARTMENT OF ENVIRONMENTAL SERVICES



Thomas S. Burack, Commissioner

October 09, 2015

City of Portsmouth
c/o Terry Desmarais
680 Peverly Hill Rd.
Portsmouth, NH 03801

RE: File #2015-01878 - City of Portsmouth - Portsmouth
Tax Map/Lot # 208 / 1

Dear Property Owner:

The Department of Environmental Services (DES) Wetlands Bureau has reviewed and approved the above referenced application to impact 1,040 square feet (150 linear feet) of tidal wetlands and a total of 2,445 square feet of undeveloped upland tidal buffer zone (320 sq. ft. temporary and 2,125 sq. ft. permanent impacts) over three locations for installation of rip rap revetment for shoreline bank stabilization associated with upgrade construction at the Portsmouth Pierce Island Wastewater Treatment Facility in accordance with an EPA Consent Decree.

Any person aggrieved by this decision may appeal to the N.H. Wetlands Council ("Council") by filing an appeal that meets the requirements specified in RSA 482-A:10, RSA 21-O:14, and the rules adopted by the Council, Env-WtC 100-200. The appeal must be filed **directly with the Council within 30 days** of the date of this decision and must set forth fully **every ground** upon which it is claimed that the decision complained of is unlawful or unreasonable. Only those grounds set forth in the notice of appeal can be considered by the Council.

Information about the Council, including a link to the Council's rules, is available at <http://nhec.nh.gov/> (or more directly at <http://nhec.nh.gov/wetlands/index.htm>.) Copies of the rules also are available from the DES Public Information Center at (603) 271-2975.

Because of the type and classification of this project, the application must also be approved by the Governor and Executive Council. Upon completion of the appeal period, a copy of the file will be forwarded to the Governor and Executive Council for their consideration.

Sincerely,

Collis G. Adams, CWS, CPESC
Wetlands Bureau Administrator

CGA/emk

Enclosure: copy of decision

cc: Portsmouth Conservation Commission
Portsmouth Board of Selectmen
Jon Pearson, AECOM
Abutters

DECISION DATE: 10/09/2015

DECISION:

Impact 1,040 square feet (150 linear feet) of tidal wetlands and a total of 2,445 square feet of undeveloped upland tidal buffer zone (320 sq. ft. temporary and 2,125 sq. ft. permanent impacts) over three locations for installation of rip rap revetment for shoreline bank stabilization associated with upgrade construction at the Portsmouth Pierce Island Wastewater Treatment Facility in accordance with an EPA Consent Decree.

CONDITIONS:

1. All work shall be in accordance with plans by AECOM dated July 2015, as received by the NH Department of Environmental Services (DES) on July 21, 2015.
2. This permit is not valid unless an Alteration of Terrain permit or other method of compliance with RSA 485-A:17 and Env-Wq 1500 is achieved.
3. Orange construction fence shall be installed around permitted impact areas to avoid activities from creeping into unintended areas.
4. Appropriate siltation and erosion controls shall be in place prior to construction, shall be maintained during construction, and shall remain in place until the area is stabilized. Temporary siltation and erosion controls shall be removed once the area has been stabilized.
5. Relative to the protection of the state-threatened Marsh Elder populations the following conditions shall be adhered to:
 - a. No construction activity or equipment staging will occur outside of erosion control limits, approximately 40 feet from Marsh Elder populations;
 - b. Construction safety fencing shall be installed along either side of Pierce Island Road during the construction;
 - c. During the construction season (Dec. 1- Apr. 30) erosion control fencing will be installed around the seasonal construction trailer/staging area, located adjacent to the eastern end of Sub-population 1;
 - d. Before construction fencing is removed at the end of the construction season, and /or upon termination of the project, care should be taken to remove any sedimentation that has collected along the fence, so that it does not run off with storm water and impact the Marsh Elder.
6. Any further alteration of areas on this property that are subject to RSA 482-A jurisdiction will require a new application and further permitting.
7. All development activities associated with this project shall be conducted in compliance with applicable requirements of RSA 483-B and N.H. Code Admin. Rules Env-Wq 1400 during and after construction.
8. No person undertaking any activity shall cause or contribute to, or allow the activity to cause or contribute to, any violations of the surface water quality standards in RSA 485-A and Env-Wq 1700.
9. Erosion control products shall be installed per manufacturers recommended specifications.
10. The contractor responsible for completion of the work shall use techniques described in the New Hampshire Stormwater Manual, Volume 3, Erosion and Sediment Controls During Construction (December 2008).
11. No concrete is to be used anywhere in the construction of the stone riprap revetment. All stone shall be dry laid or placed stone underlain with filter fabric.
12. All temporary impacts shall be remediated back to natural contours and stabilized with native seed mix, as well as planted according to the approved landscape plan immediately upon completion of project construction use of the site.
13. A report documenting such restoration shall be submitted to DES within 30 days of the restoration activities being completed.
14. Construction equipment shall be inspected daily for leaking fuel, oil, and hydraulic fluid prior to entering surface waters or wetlands or operating in an area where such fluids could reach groundwater, surface waters, or wetlands.
15. The permittee's contractor shall maintain appropriate oil/diesel fuel spill kits on site that are readily accessible at all times during construction, and shall train each operator in the use of the kits.
16. All refueling of equipment shall occur outside of surface waters or wetlands during construction. Machinery shall be staged and refueled in upland areas only.
17. Faulty equipment shall be repaired immediately prior to entering areas that are subject to RSA 482-A jurisdiction.

FINDINGS:

1. This is a major impact project per Administrative Rule Env-Wt 303.02(a), projects within tidal wetlands, and per Env-Wt 303.02(b) projects within 100 feet of the highest observable tide line in undeveloped uplands.
2. The need for the proposed impacts has been demonstrated by the applicant per Env-Wt 302.01. The overall project is the required upgrade of the Portsmouth Wastewater Treatment plant pursuant to an EPA consent decree. This application is for the stabilization portion of the overall project and will be executed concurrent with the construction portion of the project being permitted under file 2015-01866.
3. The applicant has provided evidence which demonstrates that this proposal is the alternative with the least adverse impact to areas and environments under the department's jurisdiction per Env-Wt 302.03. The project is confined to unstable areas adjacent to the new facility areas, and will be accomplished using natural material.
4. The applicant has demonstrated by plan and example that each factor listed in Env-Wt 302.04(a) and (c), Requirements for Application Evaluation, has been considered in the design of the project. The NH Natural Heritage Bureau ("NHB") required a field survey to locate populations of the state-threatened Marsh Elder, which was completed by Normandeau Associates and documented in a report dated July 14, 2014. NHB stated that although there are populations of the species in the immediate project vicinity, it does not expect the species to be impacted if certain stated conditions are followed. Those conditions have been included in the permit conditions.
5. DES Staff conducted a field inspection of the proposed project on August 7, 2015. Field inspection determined that the areas of erosion were severe and in close proximity to the facility, and that the stabilization work is necessary.
6. In accordance with RSA 482-A:8, DES finds that the requirements for a public hearing do not apply as the permitted project is not of substantial public interest, and will not have a significant impact on or adversely affect the values of the estuarine resource, as identified under RSA 482-A:1.
7. The Portsmouth Conservation Commission recommended approval of the project.



Project Location

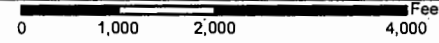

516
171

Date: 5/18/2015
 Drawn By: vchase
 Project No: 88753.08

CITY OF PORTSMOUTH
 PORTSMOUTH, NEW HAMPSHIRE
 PEIRCE ISLAND WASTEWATER TREATMENT FACILITY

EXHIBIT A - REVETMENT LOCATIONS

SCALE: 1:24,000
 NORMANDEAU environmental consultants
 25 Nashua Road Bedford, NH 03110
 (603) 472-5191 www.normandeau.com
 JUNE 2015

NHDES WETLAND PERMIT CITY OF PORTSMOUTH, NEW HAMPSHIRE

PEIRCE ISLAND WASTEWATER TREATMENT FACILITY UPGRADE JULY 2015



PROJECT
LOCATION



LOCATION PLAN
APPROXIMATE SCALE: 1" = 2,000'

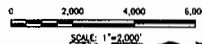

RECEIVED

JUL 21 2015

ENVIRONMENTAL SERVICES
"BY NH DES WETLANDS BUREAU"

INDEX OF SHEETS

| | |
|-----------------|--|
| 00 G-001 PERMIT | COVER SHEET, LOCATION PLAN AND INDEX OF SHEETS |
| 00 C-101 PERMIT | LEGEND, ABBREVIATIONS AND GENERAL NOTES |
| 00 C-102 PERMIT | EXISTING CONDITIONS AND EROSION CONTROL PLAN I |
| 00 C-103 PERMIT | EXISTING CONDITIONS AND EROSION CONTROL PLAN II |
| 00 C-104 PERMIT | DEMOLITION PLAN I |
| 00 C-105 PERMIT | DEMOLITION PLAN II |
| 00 C-106 PERMIT | DEMOLITION PLAN III |
| 00 C-107 PERMIT | SITE LAYOUT, PAVING, GRADING AND DRAINAGE PLAN I |
| 00 C-108 PERMIT | SITE LAYOUT, PAVING, GRADING AND DRAINAGE PLAN II |
| 00 C-109 PERMIT | SITE LAYOUT, PAVING, GRADING AND DRAINAGE PLAN III |
| 00 C-110 PERMIT | SITE LAYOUT, PAVING, GRADING AND DRAINAGE PLAN IV |
| 00 C-111 PERMIT | LANDSCAPE PLAN I |
| 00 C-112 PERMIT | LANDSCAPE PLAN II |
| 00 C-113 PERMIT | LANDSCAPE PLAN III |
| 00 C-114 PERMIT | WETLAND IMPACT PLAN KEY PLAN |
| 00 C-115 PERMIT | WETLAND IMPACT PLAN I |
| 00 C-116 PERMIT | WETLAND IMPACT PLAN II |
| 00 C-117 PERMIT | WETLAND IMPACT PLAN III |
| 00 C-118 PERMIT | ENLARGED PLANS AND SECTIONS AT REVETMENT AREAS I |
| 00 C-119 PERMIT | ENLARGED PLAN AND SECTION AT REVETMENT AREAS II |
| 00 C-120 PERMIT | DETAILS I |
| 00 C-121 PERMIT | DETAILS II |
| 00 C-122 PERMIT | DETAILS III |
| 00 C-123 PERMIT | DETAILS IV |
| 00 C-124 PERMIT | DETAILS V |
| 00 C-125 PERMIT | DETAILS VI |
| 00 C-126 PERMIT | DETAILS VII |
| 00 C-127 PERMIT | DETAILS VIII |

NOTE:

WETLANDS WERE DELINEATED BY NORMANDEAU ASSOCIATES, INC. ON JUNE 3, 2013. THE WETLAND DELINEATIONS WERE COMPLETED IN ACCORDANCE WITH THE CRITERIA DESCRIBED IN THE U.S. ARMY CORPS OF ENGINEERS WETLAND DELINEATION MANUAL TECHNICAL REPORT Y-87-1 (JANUARY, 1987) AND THE REGIONAL SUPPLEMENT FOR THE NORTH-CENTRAL AND NORTH-EAST REGION (JANUARY, 2012) AND MEET THE CRITERIA FOR WETLAND DELINEATION IN ACCORDANCE WITH THE NH DES ADMINISTRATIVE RULES ENV-WT 301.01 AND ENV-WT 101.46.



PERMIT APPLICATION DRAWING
NOT FOR CONSTRUCTION

DRAWN BY: C. SCHNEIDER
DEPT. CHECK: C. SCHNEIDER
PROJ. CHECK: E. MESSINE
DATE: JULY 2015
SCALE: AS NOTED

PROJECT NO: 000152
CAD DWG FILE: 00 G-001 -
REVISED BY: J. MARRAS

PROJECT NO: 000152
CAD DWG FILE: 00 G-001 -
REVISED BY: J. MARRAS

DRAWN BY: C. SCHNEIDER
DEPT. CHECK: C. SCHNEIDER
PROJ. CHECK: E. MESSINE
DATE: JULY 2015
SCALE: AS NOTED

00 G-001 PERMIT

GENERAL NOTES

1. UNLESS OTHERWISE SHOWN, ALL ELEVATIONS ARE REFERENCED TO THE MEAN SEA LEVEL CORRECTION SYSTEM, UNLESS OTHERWISE SHOWN.
2. UNLESS OTHERWISE SHOWN, ALL ELEVATIONS ARE REFERENCED TO THE MEAN SEA LEVEL CORRECTION SYSTEM, UNLESS OTHERWISE SHOWN.
3. UNLESS OTHERWISE SHOWN, ALL ELEVATIONS ARE REFERENCED TO THE MEAN SEA LEVEL CORRECTION SYSTEM, UNLESS OTHERWISE SHOWN.
4. UNLESS OTHERWISE SHOWN, ALL ELEVATIONS ARE REFERENCED TO THE MEAN SEA LEVEL CORRECTION SYSTEM, UNLESS OTHERWISE SHOWN.
5. UNLESS OTHERWISE SHOWN, ALL ELEVATIONS ARE REFERENCED TO THE MEAN SEA LEVEL CORRECTION SYSTEM, UNLESS OTHERWISE SHOWN.
6. UNLESS OTHERWISE SHOWN, ALL ELEVATIONS ARE REFERENCED TO THE MEAN SEA LEVEL CORRECTION SYSTEM, UNLESS OTHERWISE SHOWN.
7. UNLESS OTHERWISE SHOWN, ALL ELEVATIONS ARE REFERENCED TO THE MEAN SEA LEVEL CORRECTION SYSTEM, UNLESS OTHERWISE SHOWN.
8. UNLESS OTHERWISE SHOWN, ALL ELEVATIONS ARE REFERENCED TO THE MEAN SEA LEVEL CORRECTION SYSTEM, UNLESS OTHERWISE SHOWN.
9. UNLESS OTHERWISE SHOWN, ALL ELEVATIONS ARE REFERENCED TO THE MEAN SEA LEVEL CORRECTION SYSTEM, UNLESS OTHERWISE SHOWN.
10. UNLESS OTHERWISE SHOWN, ALL ELEVATIONS ARE REFERENCED TO THE MEAN SEA LEVEL CORRECTION SYSTEM, UNLESS OTHERWISE SHOWN.
11. UNLESS OTHERWISE SHOWN, ALL ELEVATIONS ARE REFERENCED TO THE MEAN SEA LEVEL CORRECTION SYSTEM, UNLESS OTHERWISE SHOWN.
12. UNLESS OTHERWISE SHOWN, ALL ELEVATIONS ARE REFERENCED TO THE MEAN SEA LEVEL CORRECTION SYSTEM, UNLESS OTHERWISE SHOWN.

VERTICAL CURVE CONVERSION NOTE:

VERTICAL CURVE CONVERSION NOTE: ALL VERTICAL CURVE DATA IS BASED ON THE MEAN SEA LEVEL CORRECTION SYSTEM, UNLESS OTHERWISE SHOWN. ALL ELEVATIONS ARE REFERENCED TO THE MEAN SEA LEVEL CORRECTION SYSTEM, UNLESS OTHERWISE SHOWN.

ABBREVIATIONS

| Abbreviation | Full Name |
|--------------|-----------------|
| AP | APPROXIMATE |
| AS | ASBESTOS |
| BL | BUILDING |
| BR | BROWSE |
| CA | CADASTRAL |
| CB | CORNER BENCH |
| CC | CONCRETE |
| CD | CONCRETE DETAIL |
| CE | CONCRETE |
| CF | CORNER |
| CG | CORNER |
| CH | CHIMNEY |
| CI | CORNER |
| CJ | CORNER |
| CK | CORNER |
| CL | CORNER |
| CM | CORNER |
| CN | CORNER |
| CO | CORNER |
| CP | CORNER |
| CQ | CORNER |
| CR | CORNER |
| CS | CORNER |
| CT | CORNER |
| CU | CORNER |
| CV | CORNER |
| CW | CORNER |
| CX | CORNER |
| CY | CORNER |
| CZ | CORNER |
| DA | CORNER |
| DB | CORNER |
| DC | CORNER |
| DD | CORNER |
| DE | CORNER |
| DF | CORNER |
| DG | CORNER |
| DH | CORNER |
| DI | CORNER |
| DJ | CORNER |
| DK | CORNER |
| DL | CORNER |
| DM | CORNER |
| DN | CORNER |
| DO | CORNER |
| DP | CORNER |
| DQ | CORNER |
| DR | CORNER |
| DS | CORNER |
| DT | CORNER |
| DU | CORNER |
| DV | CORNER |
| DW | CORNER |
| DX | CORNER |
| DY | CORNER |
| DZ | CORNER |
| EA | CORNER |
| EB | CORNER |
| EC | CORNER |
| ED | CORNER |
| EE | CORNER |
| EF | CORNER |
| EG | CORNER |
| EH | CORNER |
| EI | CORNER |
| EJ | CORNER |
| EK | CORNER |
| EL | CORNER |
| EM | CORNER |
| EN | CORNER |
| EO | CORNER |
| EP | CORNER |
| EQ | CORNER |
| ER | CORNER |
| ES | CORNER |
| ET | CORNER |
| EU | CORNER |
| EV | CORNER |
| EW | CORNER |
| EX | CORNER |
| EY | CORNER |
| EZ | CORNER |
| FA | CORNER |
| FB | CORNER |
| FC | CORNER |
| FD | CORNER |
| FE | CORNER |
| FF | CORNER |
| FG | CORNER |
| FH | CORNER |
| FI | CORNER |
| FJ | CORNER |
| FK | CORNER |
| FL | CORNER |
| FM | CORNER |
| FN | CORNER |
| FO | CORNER |
| FP | CORNER |
| FQ | CORNER |
| FR | CORNER |
| FS | CORNER |
| FT | CORNER |
| FU | CORNER |
| FV | CORNER |
| FW | CORNER |
| FX | CORNER |
| FY | CORNER |
| FZ | CORNER |
| GA | CORNER |
| GB | CORNER |
| GC | CORNER |
| GD | CORNER |
| GE | CORNER |
| GF | CORNER |
| GG | CORNER |
| GH | CORNER |
| GI | CORNER |
| GJ | CORNER |
| GK | CORNER |
| GL | CORNER |
| GM | CORNER |
| GN | CORNER |
| GO | CORNER |
| GP | CORNER |
| GQ | CORNER |
| GR | CORNER |
| GS | CORNER |
| GT | CORNER |
| GU | CORNER |
| GV | CORNER |
| GW | CORNER |
| GX | CORNER |
| GY | CORNER |
| GZ | CORNER |
| HA | CORNER |
| HB | CORNER |
| HC | CORNER |
| HD | CORNER |
| HE | CORNER |
| HF | CORNER |
| HG | CORNER |
| HH | CORNER |
| HI | CORNER |
| HJ | CORNER |
| HK | CORNER |
| HL | CORNER |
| HM | CORNER |
| HN | CORNER |
| HO | CORNER |
| HP | CORNER |
| HQ | CORNER |
| HR | CORNER |
| HS | CORNER |
| HT | CORNER |
| HU | CORNER |
| HV | CORNER |
| HW | CORNER |
| HX | CORNER |
| HY | CORNER |
| HZ | CORNER |
| IA | CORNER |
| IB | CORNER |
| IC | CORNER |
| ID | CORNER |
| IE | CORNER |
| IF | CORNER |
| IG | CORNER |
| IH | CORNER |
| II | CORNER |
| IJ | CORNER |
| IK | CORNER |
| IL | CORNER |
| IM | CORNER |
| IN | CORNER |
| IO | CORNER |
| IP | CORNER |
| IQ | CORNER |
| IR | CORNER |
| IS | CORNER |
| IT | CORNER |
| IU | CORNER |
| IV | CORNER |
| IW | CORNER |
| IX | CORNER |
| IY | CORNER |
| IZ | CORNER |
| JA | CORNER |
| JB | CORNER |
| JC | CORNER |
| JD | CORNER |
| JE | CORNER |
| JF | CORNER |
| JG | CORNER |
| JH | CORNER |
| JI | CORNER |
| JJ | CORNER |
| JK | CORNER |
| JL | CORNER |
| JM | CORNER |
| JN | CORNER |
| JO | CORNER |
| JP | CORNER |
| JQ | CORNER |
| JR | CORNER |
| JS | CORNER |
| JT | CORNER |
| JU | CORNER |
| JV | CORNER |
| JW | CORNER |
| JX | CORNER |
| JY | CORNER |
| JZ | CORNER |
| KA | CORNER |
| KB | CORNER |
| KC | CORNER |
| KD | CORNER |
| KE | CORNER |
| KF | CORNER |
| KG | CORNER |
| KH | CORNER |
| KI | CORNER |
| KJ | CORNER |
| KK | CORNER |
| KL | CORNER |
| KM | CORNER |
| KN | CORNER |
| KO | CORNER |
| KP | CORNER |
| KQ | CORNER |
| KR | CORNER |
| KS | CORNER |
| KT | CORNER |
| KU | CORNER |
| KV | CORNER |
| KW | CORNER |
| KX | CORNER |
| KY | CORNER |
| KZ | CORNER |
| LA | CORNER |
| LB | CORNER |
| LC | CORNER |
| LD | CORNER |
| LE | CORNER |
| LF | CORNER |
| LG | CORNER |
| LH | CORNER |
| LI | CORNER |
| LJ | CORNER |
| LK | CORNER |
| LL | CORNER |
| LM | CORNER |
| LN | CORNER |
| LO | CORNER |
| LP | CORNER |
| LQ | CORNER |
| LR | CORNER |
| LS | CORNER |
| LT | CORNER |
| LU | CORNER |
| LV | CORNER |
| LW | CORNER |
| LX | CORNER |
| LY | CORNER |
| LZ | CORNER |
| MA | CORNER |
| MB | CORNER |
| MC | CORNER |
| MD | CORNER |
| ME | CORNER |
| MF | CORNER |
| MG | CORNER |
| MH | CORNER |
| MI | CORNER |
| MJ | CORNER |
| MK | CORNER |
| ML | CORNER |
| MM | CORNER |
| MN | CORNER |
| MO | CORNER |
| MP | CORNER |
| MQ | CORNER |
| MR | CORNER |
| MS | CORNER |
| MT | CORNER |
| MU | CORNER |
| MV | CORNER |
| MW | CORNER |
| MX | CORNER |
| MY | CORNER |
| MZ | CORNER |
| NA | CORNER |
| NB | CORNER |
| NC | CORNER |
| ND | CORNER |
| NE | CORNER |
| NF | CORNER |
| NG | CORNER |
| NH | CORNER |
| NI | CORNER |
| NJ | CORNER |
| NK | CORNER |
| NL | CORNER |
| NM | CORNER |
| NO | CORNER |
| NP | CORNER |
| NQ | CORNER |
| NR | CORNER |
| NS | CORNER |
| NT | CORNER |
| NU | CORNER |
| NV | CORNER |
| NW | CORNER |
| NX | CORNER |
| NY | CORNER |
| NZ | CORNER |
| OA | CORNER |
| OB | CORNER |
| OC | CORNER |
| OD | CORNER |
| OE | CORNER |
| OF | CORNER |
| OG | CORNER |
| OH | CORNER |
| OI | CORNER |
| OJ | CORNER |
| OK | CORNER |
| OL | CORNER |
| OM | CORNER |
| ON | CORNER |
| OO | CORNER |
| OP | CORNER |
| OQ | CORNER |
| OR | CORNER |
| OS | CORNER |
| OT | CORNER |
| OU | CORNER |
| OV | CORNER |
| OW | CORNER |
| OX | CORNER |
| OY | CORNER |
| OZ | CORNER |
| PA | CORNER |
| PB | CORNER |
| PC | CORNER |
| PD | CORNER |
| PE | CORNER |
| PF | CORNER |
| PG | CORNER |
| PH | CORNER |
| PI | CORNER |
| PJ | CORNER |
| PK | CORNER |
| PL | CORNER |
| PM | CORNER |
| PN | CORNER |
| PO | CORNER |
| PP | CORNER |
| PQ | CORNER |
| PR | CORNER |
| PS | CORNER |
| PT | CORNER |
| PV | CORNER |
| PW | CORNER |
| PX | CORNER |
| PY | CORNER |
| PZ | CORNER |
| QA | CORNER |
| QB | CORNER |
| QC | CORNER |
| QD | CORNER |
| QE | CORNER |
| QF | CORNER |
| QG | CORNER |
| QH | CORNER |
| QI | CORNER |
| QJ | CORNER |
| QK | CORNER |
| QL | CORNER |
| QM | CORNER |
| QN | CORNER |
| QO | CORNER |
| QP | CORNER |
| QQ | CORNER |
| QR | CORNER |
| QS | CORNER |
| QT | CORNER |
| QU | CORNER |
| QV | CORNER |
| QW | CORNER |
| QX | CORNER |
| QY | CORNER |
| QZ | CORNER |
| RA | CORNER |
| RB | CORNER |
| RC | CORNER |
| RD | CORNER |
| RE | CORNER |
| RF | CORNER |
| RG | CORNER |
| RH | CORNER |
| RI | CORNER |
| RJ | CORNER |
| RK | CORNER |
| RL | CORNER |
| RM | CORNER |
| RO | CORNER |
| RP | CORNER |
| RQ | CORNER |
| RR | CORNER |
| RS | CORNER |
| RT | CORNER |
| RV | CORNER |
| RW | CORNER |
| RX | CORNER |
| RY | CORNER |
| RZ | CORNER |
| SA | CORNER |
| SB | CORNER |
| SC | CORNER |
| SD | CORNER |
| SE | CORNER |
| SF | CORNER |
| SG | CORNER |
| SH | CORNER |
| SI | CORNER |
| SJ | CORNER |
| SK | CORNER |
| SL | CORNER |
| SM | CORNER |
| SN | CORNER |
| SO | CORNER |
| SP | CORNER |
| SQ | CORNER |
| SR | CORNER |
| SS | CORNER |
| ST | CORNER |
| SV | CORNER |
| SW | CORNER |
| SX | CORNER |
| SY | CORNER |
| SZ | CORNER |
| TA | CORNER |
| TB | CORNER |
| TC | CORNER |
| TD | CORNER |
| TE | CORNER |
| TF | CORNER |
| TG | CORNER |
| TH | CORNER |
| TI | CORNER |
| TJ | CORNER |
| TK | CORNER |
| TL | CORNER |
| TM | CORNER |
| TO | CORNER |
| TP | CORNER |
| TQ | CORNER |
| TR | CORNER |
| TS | CORNER |
| TV | CORNER |
| TW | CORNER |
| TX | CORNER |
| TY | CORNER |
| TZ | CORNER |
| UA | CORNER |
| UB | CORNER |
| UC | CORNER |
| UD | CORNER |
| UE | CORNER |
| UF | CORNER |
| UG | CORNER |
| UH | CORNER |
| UI | CORNER |
| UJ | CORNER |
| UK | CORNER |
| UL | CORNER |
| UM | CORNER |
| UN | CORNER |
| UO | CORNER |
| UP | CORNER |
| UQ | CORNER |
| UR | CORNER |
| US | CORNER |
| UT | CORNER |
| UV | CORNER |
| UW | CORNER |
| UX | CORNER |
| UY | CORNER |
| UZ | CORNER |
| VA | CORNER |
| VB | CORNER |
| VC | CORNER |
| VD | CORNER |
| VE | CORNER |
| VF | CORNER |
| VG | CORNER |
| VH | CORNER |
| VI | CORNER |
| VJ | CORNER |
| VK | CORNER |
| VL | CORNER |
| VM | CORNER |
| VO | CORNER |
| VP | CORNER |
| VQ | CORNER |
| VR | CORNER |
| VS | CORNER |
| VT | CORNER |
| VU | CORNER |
| VV | CORNER |
| VW | CORNER |
| VX | CORNER |
| VY | CORNER |
| VZ | CORNER |
| WA | CORNER |
| WB | CORNER |
| WC | CORNER |
| WD | CORNER |
| WE | CORNER |
| WF | CORNER |
| WG | CORNER |
| WH | CORNER |
| WI | CORNER |
| WJ | CORNER |
| WK | CORNER |
| WL | CORNER |
| WM | CORNER |
| WN | CORNER |
| WO | CORNER |
| WP | CORNER |
| WQ | CORNER |
| WR | CORNER |
| WS | CORNER |
| WT | CORNER |
| WU | CORNER |
| WV | CORNER |
| WW | CORNER |
| WX | CORNER |
| WY | CORNER |
| WZ | CORNER |
| XA | CORNER |
| XB | CORNER |
| XC | CORNER |
| XD | CORNER |
| XE | CORNER |
| XF | CORNER |
| XG | CORNER |
| XH | CORNER |
| XI | CORNER |
| XJ | CORNER |
| XK | CORNER |
| XL | CORNER |
| XM | CORNER |
| XN | CORNER |
| XO | CORNER |
| XP | CORNER |
| XQ | CORNER |
| XR | CORNER |
| XS | CORNER |
| XT | CORNER |
| XV | CORNER |
| XW | CORNER |
| XX | CORNER |
| XY | CORNER |
| XZ | CORNER |
| YA | CORNER |
| YB | CORNER |
| YC | CORNER |
| YD | CORNER |
| YE | CORNER |
| YF | CORNER |
| YG | CORNER |
| YH | CORNER |
| YI | CORNER |
| YJ | CORNER |
| YK | CORNER |
| YL | CORNER |
| YM | CORNER |
| YN | CORNER |
| YO | CORNER |
| YP | CORNER |
| YQ | CORNER |
| YR | CORNER |
| YS | CORNER |
| YT | CORNER |
| YU | CORNER |
| YV | CORNER |
| YW | CORNER |
| YX | CORNER |
| YY | CORNER |
| YZ | CORNER |
| ZA | CORNER |
| ZB | CORNER |
| ZC | CORNER |
| ZD | CORNER |
| ZE | CORNER |
| ZF | CORNER |
| ZG | CORNER |
| ZH | CORNER |
| ZI | CORNER |
| ZJ | CORNER |
| ZK | CORNER |
| ZL | CORNER |
| ZM | CORNER |
| ZN | CORNER |
| ZO | CORNER |
| ZP | CORNER |
| ZQ | CORNER |
| ZR | CORNER |
| ZS | CORNER |
| ZT | CORNER |
| ZU | CORNER |
| ZV | CORNER |
| ZW | CORNER |
| ZX | CORNER |
| ZY | CORNER |
| ZZ | CORNER |

EXISTING

LEGEND

PROPOSED

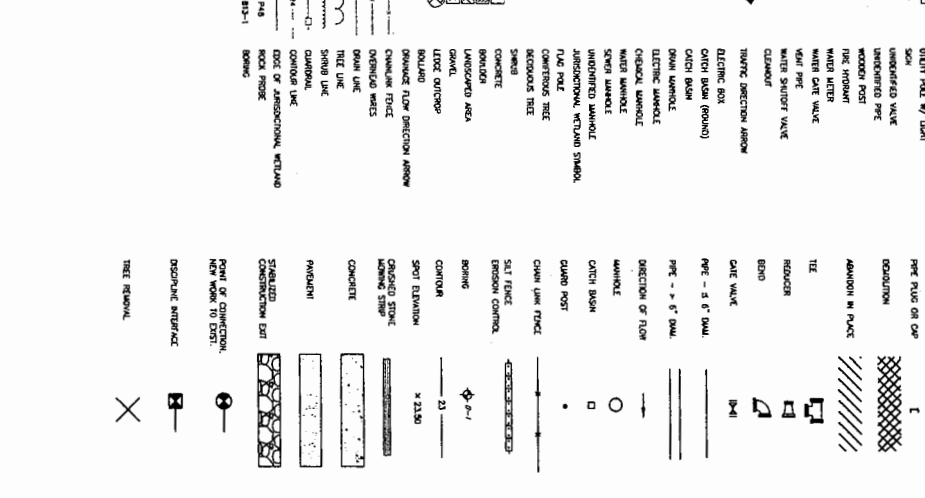

CITY OF PORTSMOUTH, NH - DEPARTMENT OF PUBLIC WORKS

PEIRCE ISLAND WWTF UPGRADE

LEGEND, ABBREVIATIONS AND GENERAL NOTES

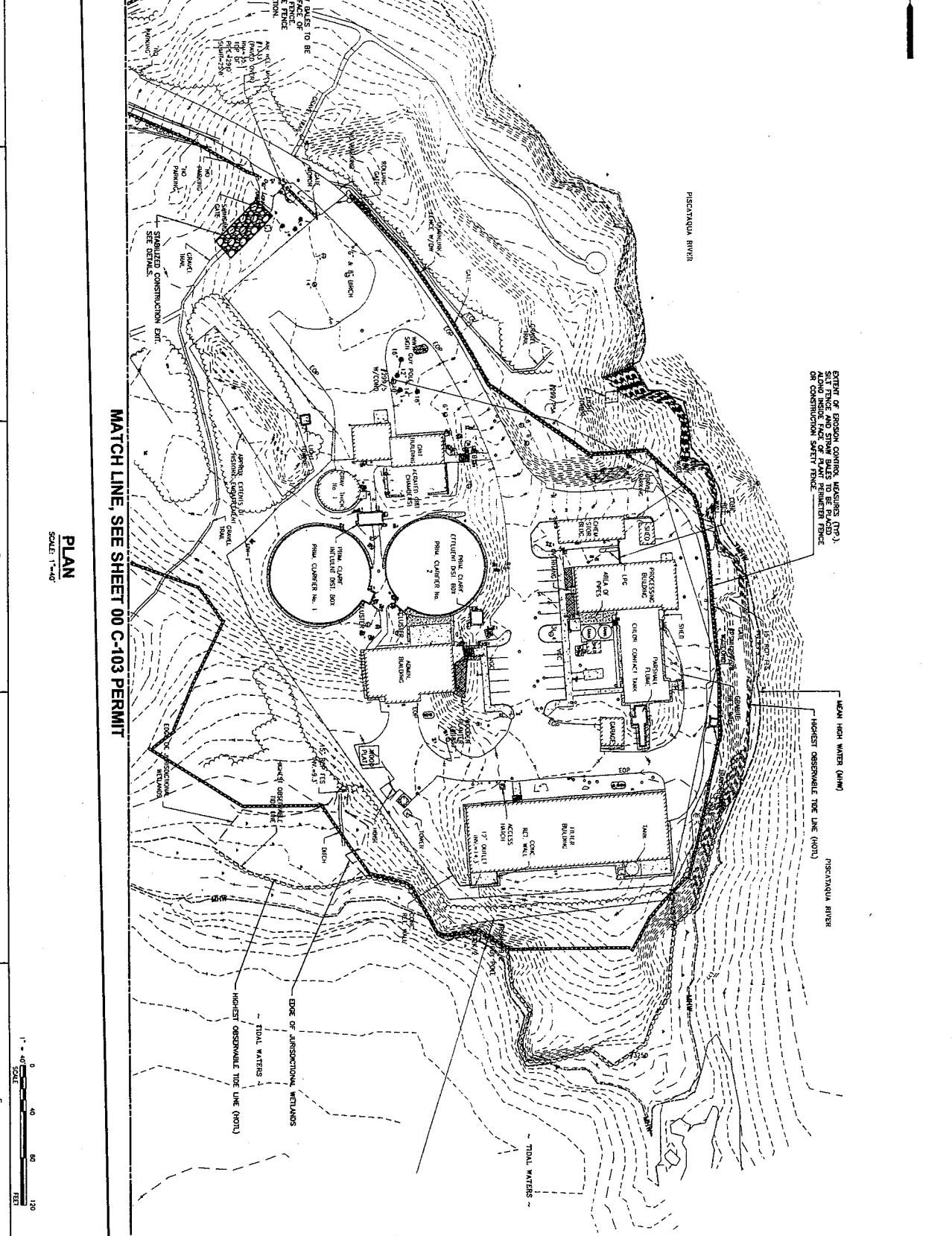

PLAN
SCALE: 1"=40'

MATCH LINE, SEE SHEET 00 C-103 PERMIT



| | | | | |
|------------------------|---|--|--|---|
| <p>00 C-102 PERMIT</p> | <p>CITY OF PORTSMOUTH, NH - DEPARTMENT OF PUBLIC WORKS PEIRCE ISLAND WWT# UPGRADE EXISTING CONDITIONS AND EROSION CONTROL PLAN I PERMITTING</p> | | <p>AECOM 2000 BETHUNE DRIVE, SUITE 200 PORTSMOUTH, NH 03801 PHONE: (603) 863-1000 FAX: (603) 863-1001</p> | <p>PERMIT APPLICATION DRAWING NOT FOR CONSTRUCTION</p> |
| | <p>PROJECT NO. 00011325 DESIGNED BY: C. BODDICE DRAWN BY: C. BODDICE CHECKED BY: E. MERRIN DATE: MAY 2015 SCALE: AS SHOWN</p> | <p>DATE: _____ DRAWN BY: _____ CHECKED BY: _____ DESCRIPTION: _____ REVISIONS: _____</p> | | |

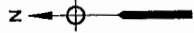

MATCH LINE, SEE SHEET 00 C-102 PERMIT

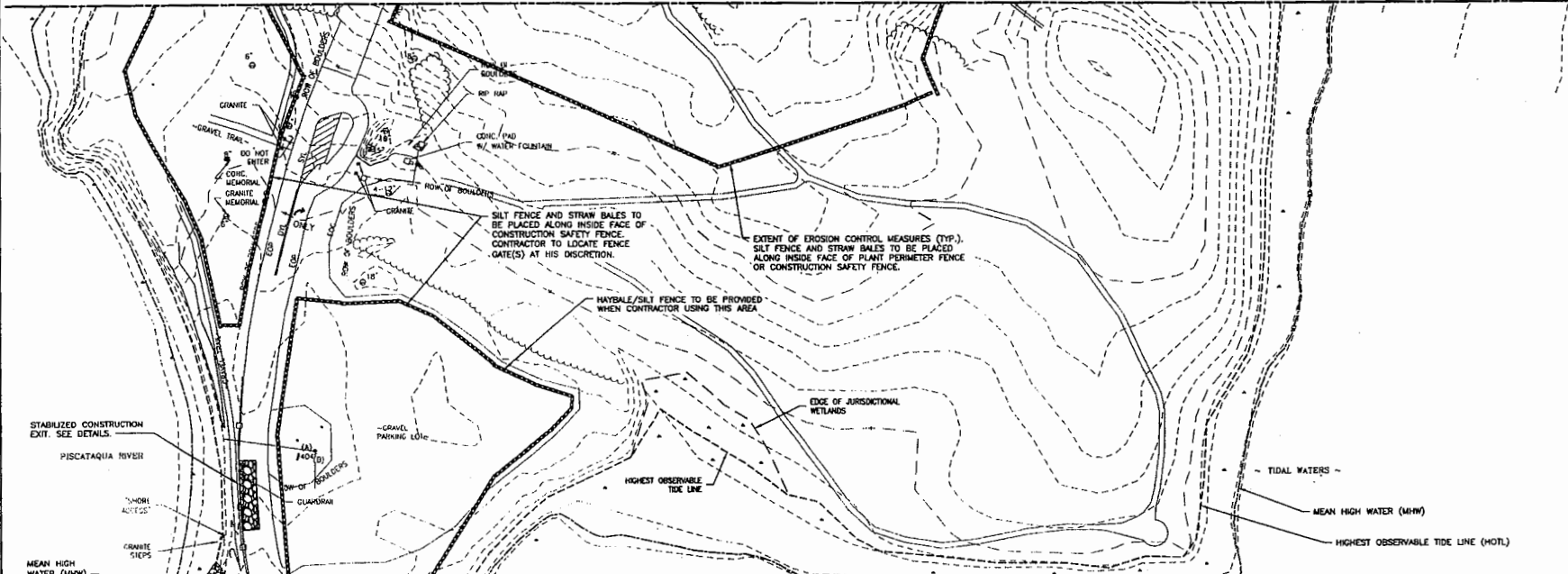

PLAN
SCALE: 1"=40'

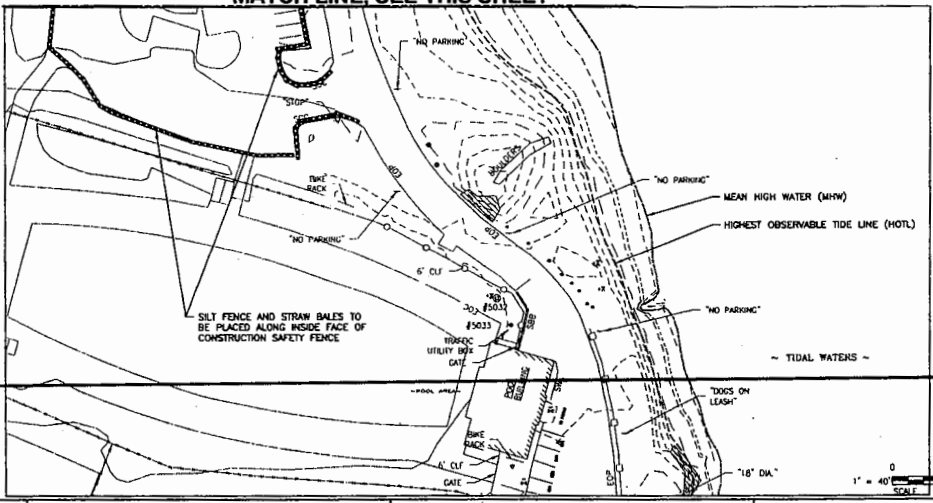

MATCH LINE, SEE THIS SHEET

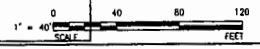

MATCH LINE, SEE THIS SHEET



PERMIT APPLICATION DRAWING
NOT FOR CONSTRUCTION







CITY OF PORTSMOUTH, NH - DEPARTMENT OF PUBLIC WORKS
 PERICE ISLAND WWTP UPGRADE
**EXISTING CONDITIONS AND
 EROSION CONTROL PLAN II**
 PERMITTING

PROJECT NO: 00001025
 CAD DWG FILE: 00 C-103
 DESIGNED BY: T. WASSILL
 DRAWN BY: C. BENZNER
 DEPT CHECK: C. BENZNER
 PROJ CHECK: E. MERRINE
 DATE: JULY 2015
 SCALE: AS NOTED

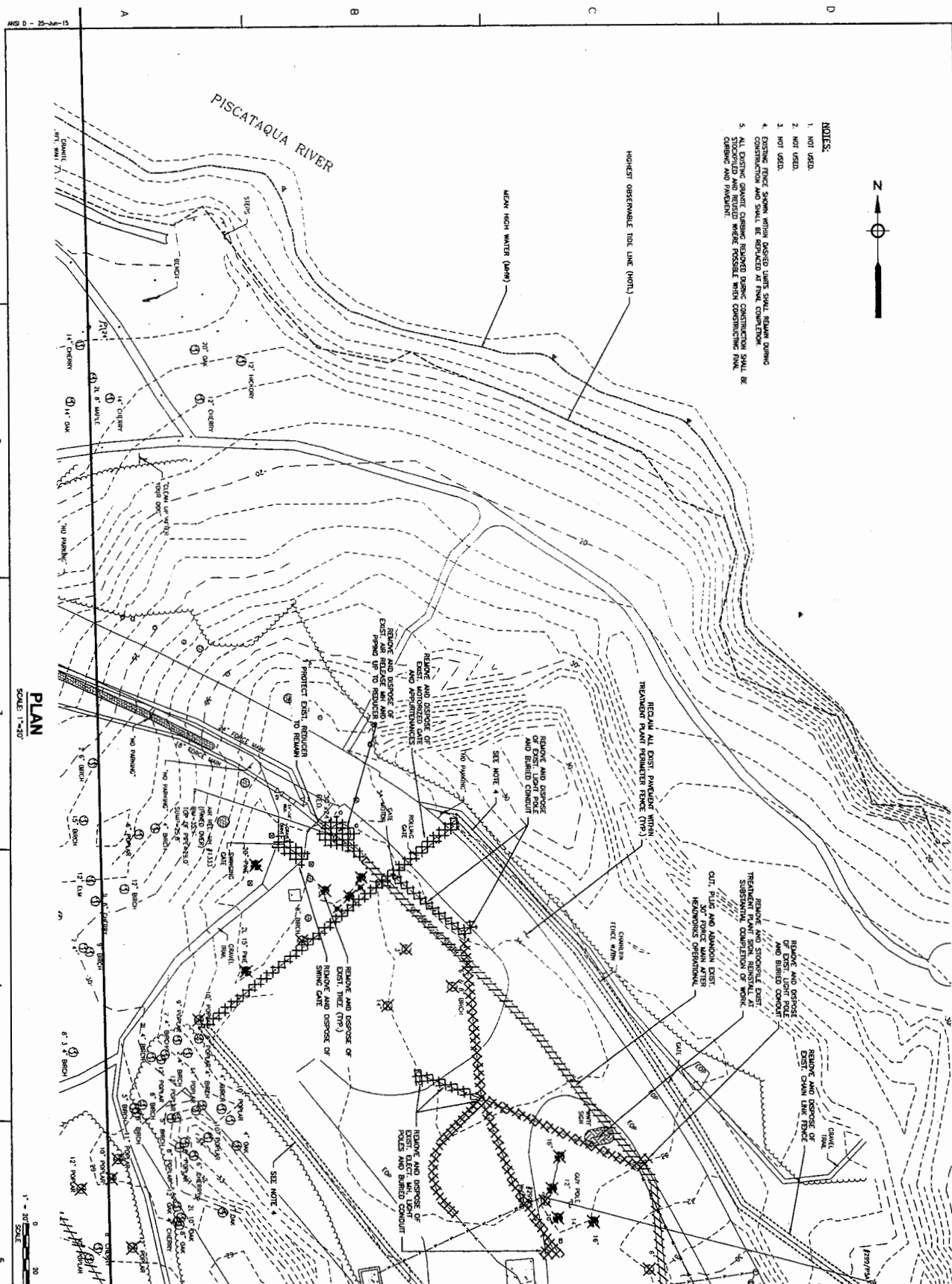
00 C-103 PERMIT



- NOTES:**
1. NOT USED.
 2. NOT USED.
 3. NOT USED.
 4. EXISTING TREES SHOWN WITHIN DESIGN LIMITS SHALL REMAIN DURING CONSTRUCTION AND SHALL BE REPLACED AT FINAL COMPLETION.
 5. ALL EXISTING GRANITE CURBING REMOVED DURING CONSTRUCTION SHALL BE STOCKPILED AND REUSED WHERE POSSIBLE WITHIN CONSTRUCTION FOOT CROWN AND THROATLINE.



PLAN
SCALE: 1"=20'



MATCH LINE, SEE SHEET 00 C-106 PERMIT

MATCH LINE, SEE SHEET 00 C-105 PERMIT

| |
|-----------------------------|
| PROJECT NO. 00-C-104 PERMIT |
| DESIGNED BY: J. WILSON |
| CHECKED BY: C. BROWN |
| DATE: JAN 2015 |
| SCALE: AS NOTED |

CITY OF PORTSMOUTH, NH - DEPARTMENT OF PUBLIC WORKS
 PEIRCE ISLAND WWTF UPGRADE
 DEMOLITION PLAN I
 PERMITTING



AECOM

ALTUS

NORMANDEAU

PERMIT APPLICATION DRAWING
 NOT FOR CONSTRUCTION

| MARK | DATE | MADE BY | CHECKED | DESCRIPTION |
|------|------|---------|---------|-------------|
| | | | | |

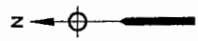

PISCATAQUA RIVER

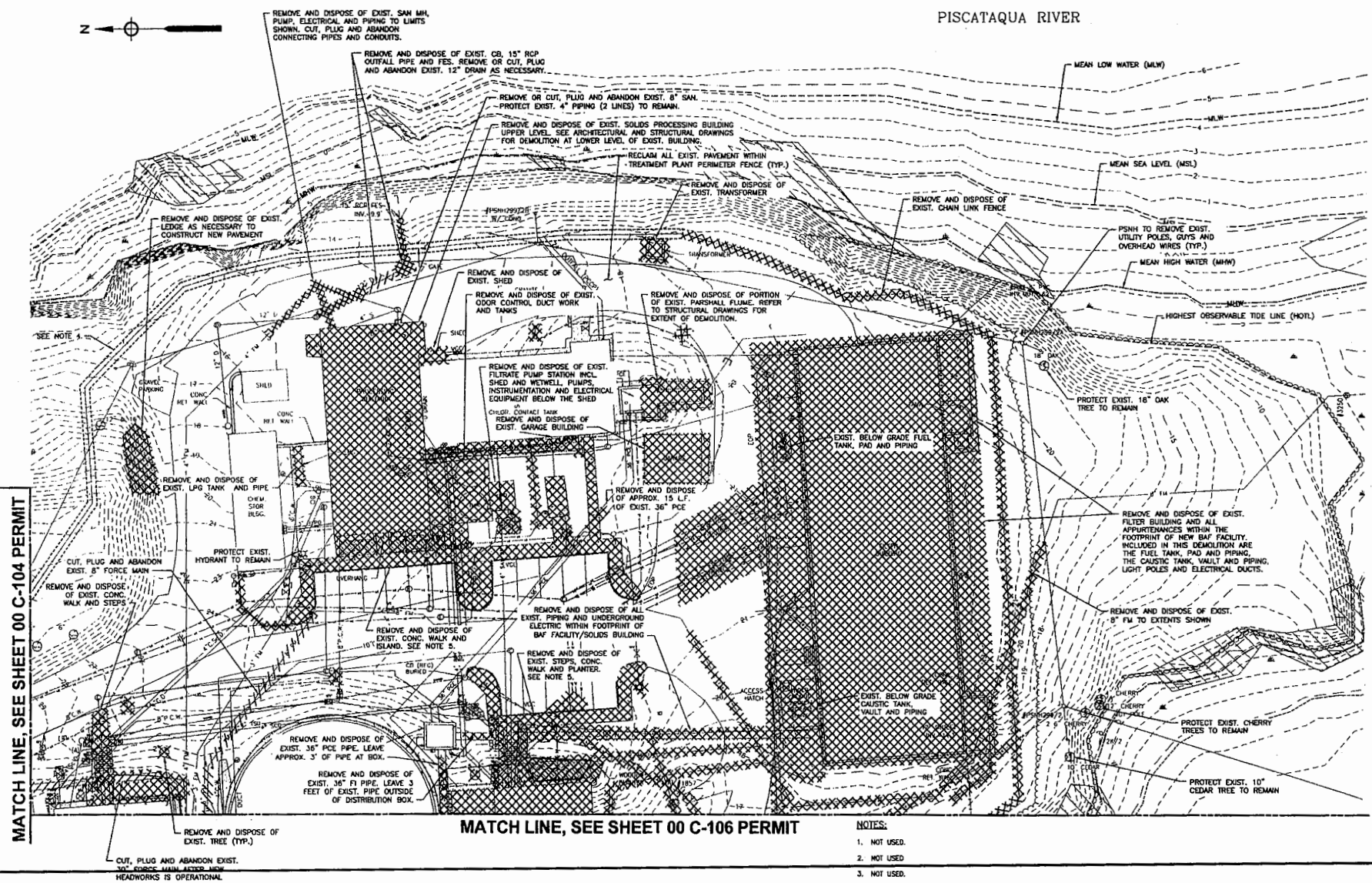

MATCH LINE, SEE SHEET 00 C-104 PERMIT

MATCH LINE, SEE SHEET 00 C-106 PERMIT

NOTES:

1. NOT USED.
2. NOT USED.
3. NOT USED.
4. EXISTING FENCE SHOWN WITH DASHED LIMITS SHALL REMAIN DURING CONSTRUCTION AND SHALL BE REPLACED AT FINAL COMPLETION.
5. ALL EXISTING GRANITE CURBING REMAINED DURING CONSTRUCTION SHALL BE STOCKPILED AND REUSED WHERE POSSIBLE WHEN CONSTRUCTING FINAL CURBING AND PAVEMENT.

PLAN
SCALE: 1"=20'

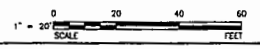

PERMIT APPLICATION DRAWING
NOT FOR CONSTRUCTION

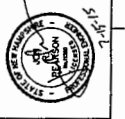

CITY OF PORTSMOUTH, NH - DEPARTMENT OF PUBLIC WORKS
PERICE ISLAND WWTF UPGRADE
DEMOLITION PLAN II
PERMITTING

PROJECT NO: 80301520
CAD DWG FILE: 00-00-108 - PERMIT
DESIGNED BY: T. BUSSELL
DRAWN BY: H. YEE
DEPT CHECK: C. BOZDOR
PROJ CHECK: E. MESSINE
DATE: JULY 2015
SCALE: AS NOTED

00 C-105 PERMIT

DATE PLOTTED: 7/21/15 11:41:01 AM
PLOT BY: T. BUSSELL

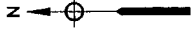

MATCH LINE, SEE SHEET 00 C-105 PERMIT

MATCH LINE, SEE SHEET 00 C-104 PERMIT

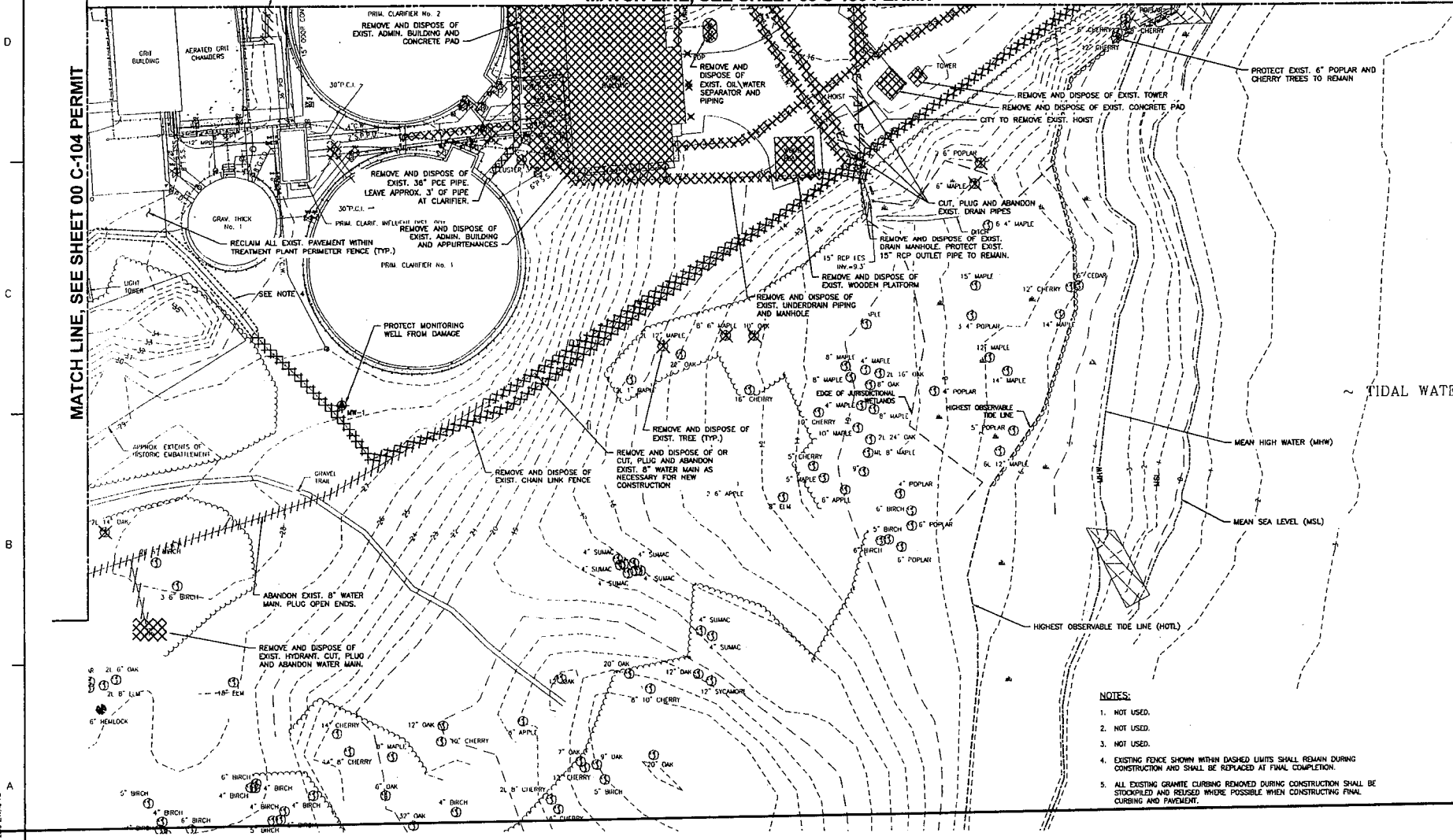

NOTES:

1. NOT USED.
2. NOT USED.
3. NOT USED.
4. EXISTING FENCE SHOWN WITHIN DASHED LIMITS SHALL REMAIN DURING CONSTRUCTION AND SHALL BE REPLACED AT FINAL COMPLETION.
5. ALL EXISTING GRANITE CURBING REMOVED DURING CONSTRUCTION SHALL BE STOCKPILED AND REUSED WHERE POSSIBLE WHEN CONSTRUCTING FINAL CURBING AND PAVEMENT.

PLAN
SCALE: 1"=20'



| | |
|---|--|
| PERMIT APPLICATION DRAWING NOT FOR CONSTRUCTION | |
| AECOM | ALTUS |
| | |
| CITY OF PORTSMOUTH, NH - DEPARTMENT OF PUBLIC WORKS PIERCE ISLAND WHITE UPGRADE DEMOLITION PLAN III PERMITTING | PROJECT NO: 10021022 CADD FILE: 10-104 - PERM DRAWN BY: K. YEE DPT CHECK: C. BENDISER PROJ CHECK: E. MESSENGER DATE: JULY 2015 SCALE: AS NOTED |
| 00 C-106 PERMIT | |

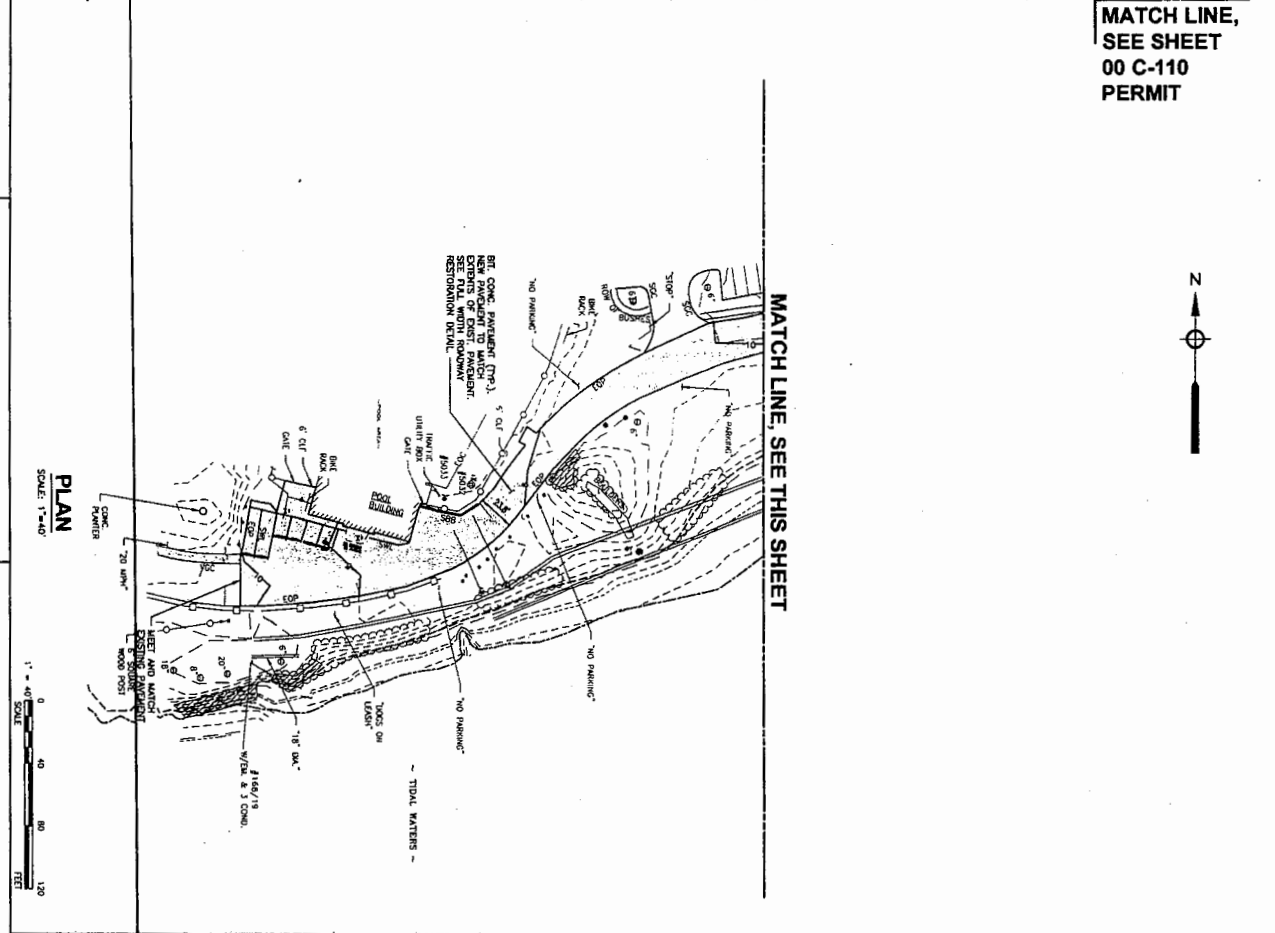
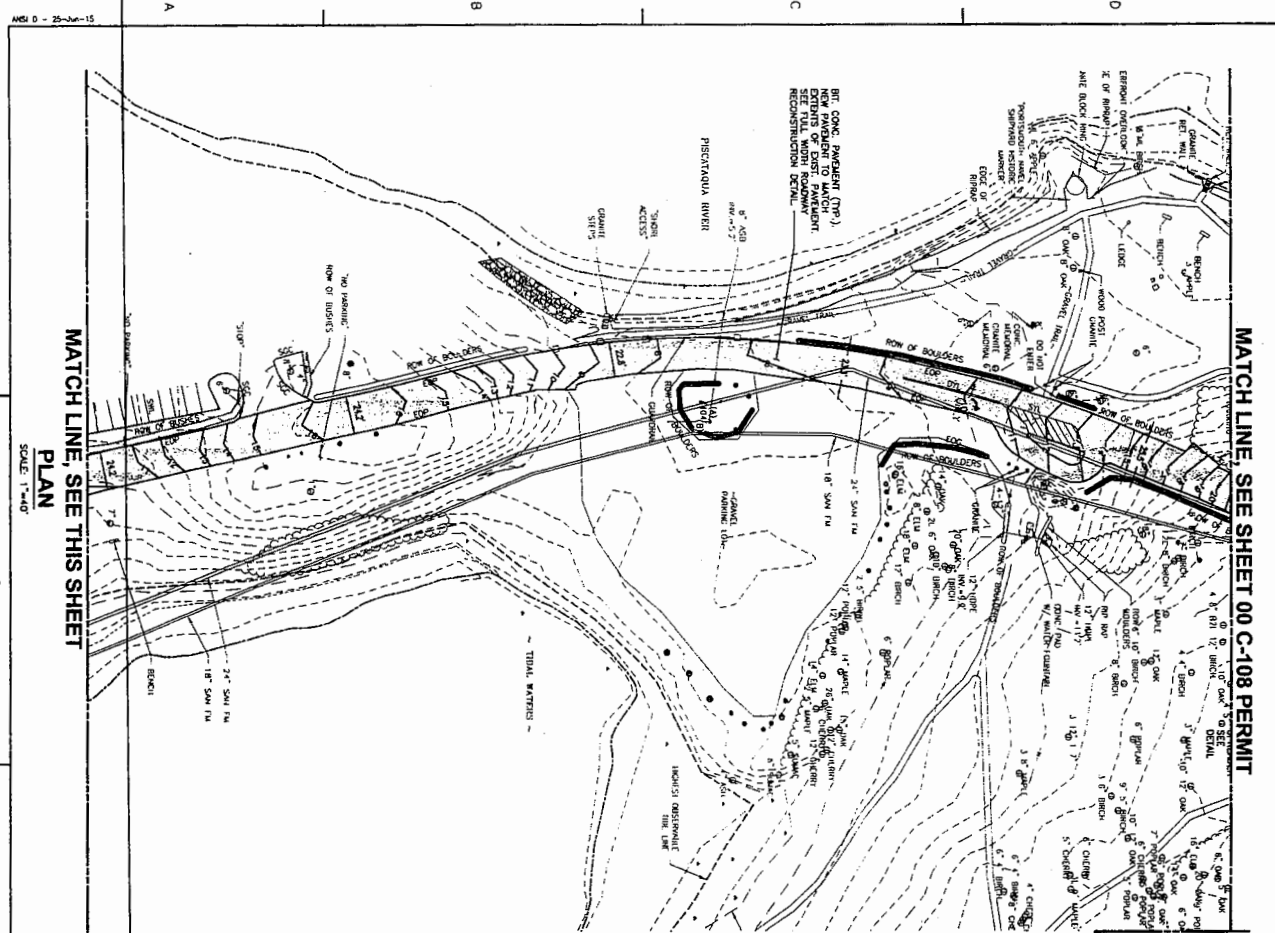

| | | | | | | |
|---|--|---|---|--|---|--|
| PROJECT NO. 000025 CITY OF PORTSMOUTH, NH - DEPARTMENT OF PUBLIC WORKS PEIRCE ISLAND WWTF UPGRADE SITE LAYOUT, PAVING, GRADING AND DRAINAGE PLAN I PERMITTING | | AECOM 100 WATER STREET PORTSMOUTH, NH 02871 TEL: 603.876.1000 FAX: 603.876.1001 WWW.AECOM.COM | ALTUS 100 WATER STREET PORTSMOUTH, NH 02871 TEL: 603.876.1000 FAX: 603.876.1001 WWW.AECOM.COM | NORMANDEAU 100 WATER STREET PORTSMOUTH, NH 02871 TEL: 603.876.1000 FAX: 603.876.1001 WWW.AECOM.COM | PERMIT APPLICATION DRAWING NOT FOR CONSTRUCTION | |
| | | | | | PROJECT NO. 000025 SHEET NO. 1 OF 1 DATE: 11/15/17 SCALE: AS SHOWN | MARK DATE MADE BY CHECKED DESCRIPTION REVISIONS |

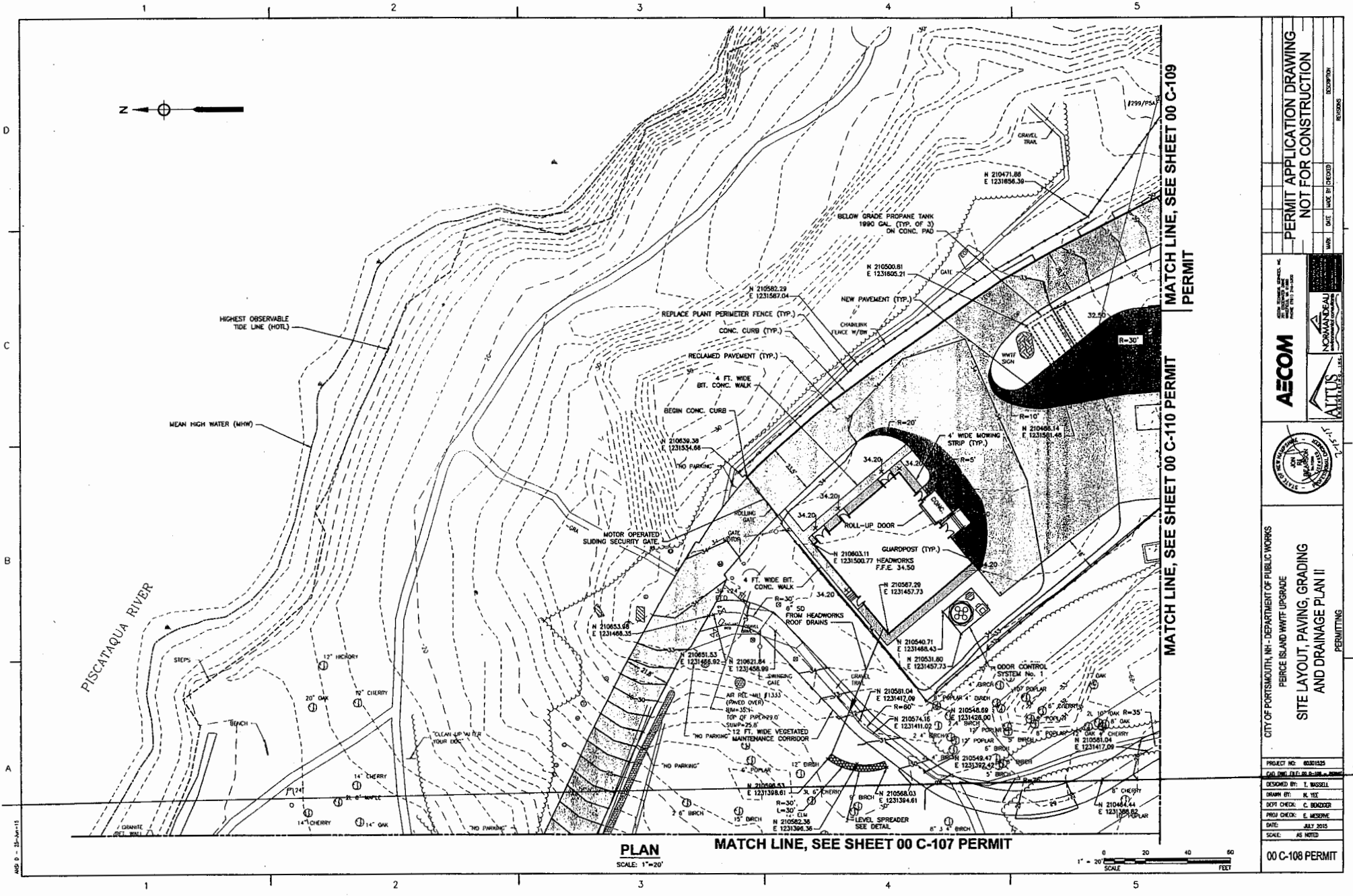

PLAN
SCALE: 1"=20'

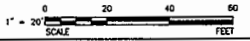

MATCH LINE, SEE SHEET 00 C-110 PERMIT

MATCH LINE, SEE SHEET 00 C-109 PERMIT

| | |
|---|---|
| | |
| | |
| | |
| | |
| PERMIT APPLICATION DRAWING NOT FOR CONSTRUCTION | |
| PROJECT NO. 0001125 PLAN NO. 00 C-108 PERMIT | CITY OF PORTSMOUTH, NH - DEPARTMENT OF PUBLIC WORKS FENCE ISLAND WHARF UPGRADE SITE LAYOUT, PAVING, GRADING AND DRAINAGE PLAN II |
| DESIGNED BY: T. WISSELL DRAWN BY: N. TIE CHECKED BY: C. ROSSIGNOL PREP. CHECKED BY: E. MERRIN DATE: JUL 2015 SCALE: AS NOTED | PERMITTING 00 C-108 PERMIT |

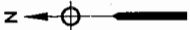

PISCATAQUA RIVER

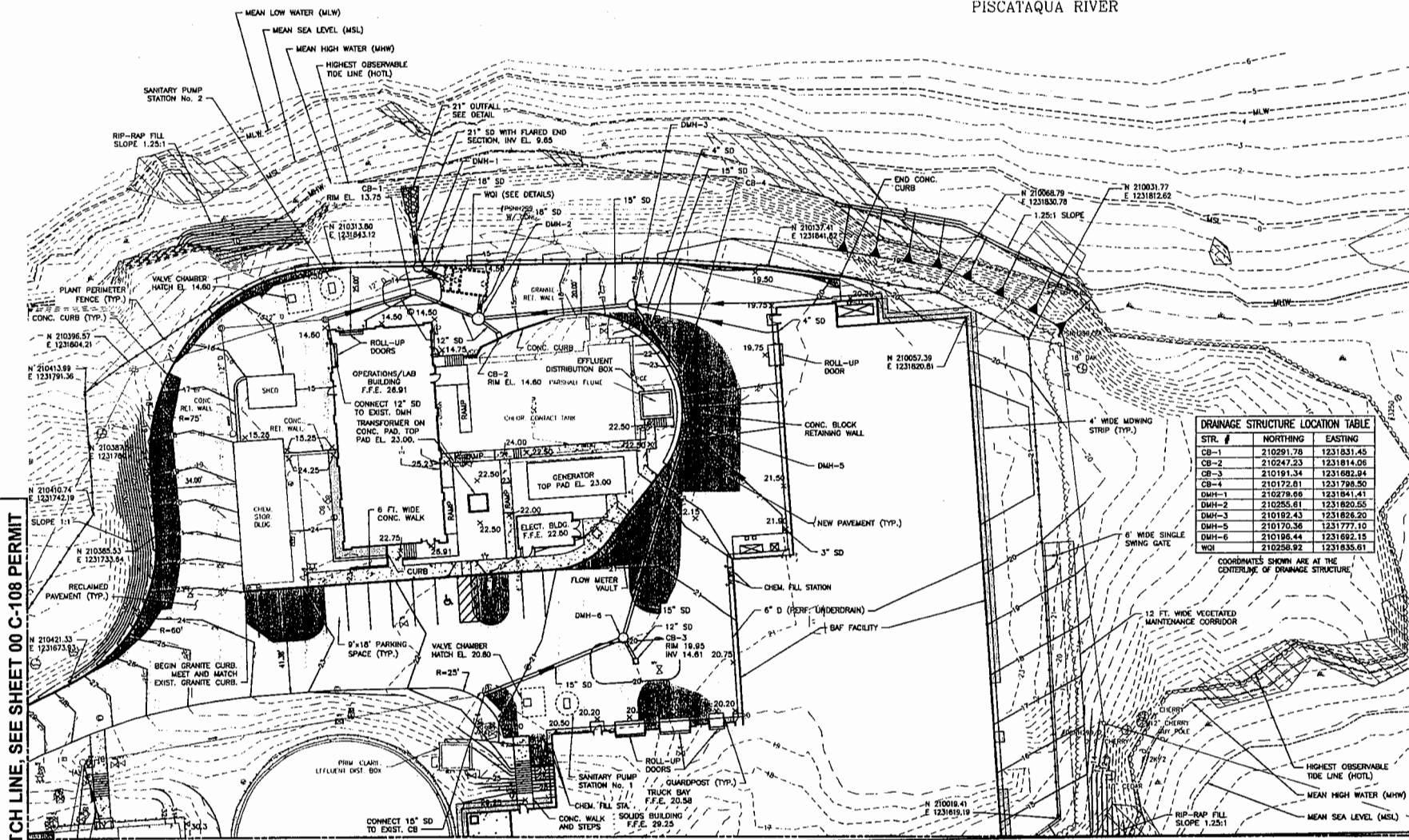

DRAINAGE STRUCTURE LOCATION TABLE

| STR. # | NORTHING | EASTING |
|--------|-----------|------------|
| CB-1 | 210291.78 | 1231831.45 |
| CB-2 | 210247.23 | 1231814.06 |
| CB-3 | 210191.34 | 1231692.84 |
| CB-4 | 210172.81 | 1231798.50 |
| DMH-1 | 210278.68 | 1231841.41 |
| DMH-2 | 210255.61 | 1231820.55 |
| DMH-3 | 210182.43 | 1231826.20 |
| DMH-5 | 210170.36 | 1231777.10 |
| DMH-6 | 210195.44 | 1231692.15 |
| WCI | 210258.92 | 1231835.61 |

COORDINATES SHOWN ARE AT THE CENTERLINE OF DRAINAGE STRUCTURE

MATCH LINE, SEE SHEET 00 C-108 PERMIT

MATCH LINE, SEE SHEET 00 C-110 PERMIT

PLAN
SCALE: 1"=20'

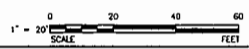

PERMIT APPLICATION DRAWING
NOT FOR CONSTRUCTION

AECOM

ALTUS

NOVATEK



CITY OF PORTSMOUTH, NH - DEPARTMENT OF PUBLIC WORKS
PERCE ISLAND WWTF UPGRADE
SITE LAYOUT, PAVING, GRADING
AND DRAINAGE PLAN III

PROJECT NO: 0001325
CAD DWG FILE: 00 C-109 - PERMIT
DESIGNED BY: T. BISSILLI
DRAWN BY: H. YEE
DPT CHECK: C. BOEDDGER
PROJ CHECK: E. MESSINE
DATE: JULY 2015
SCALE: AS NOTED

00 C-109 PERMIT

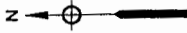
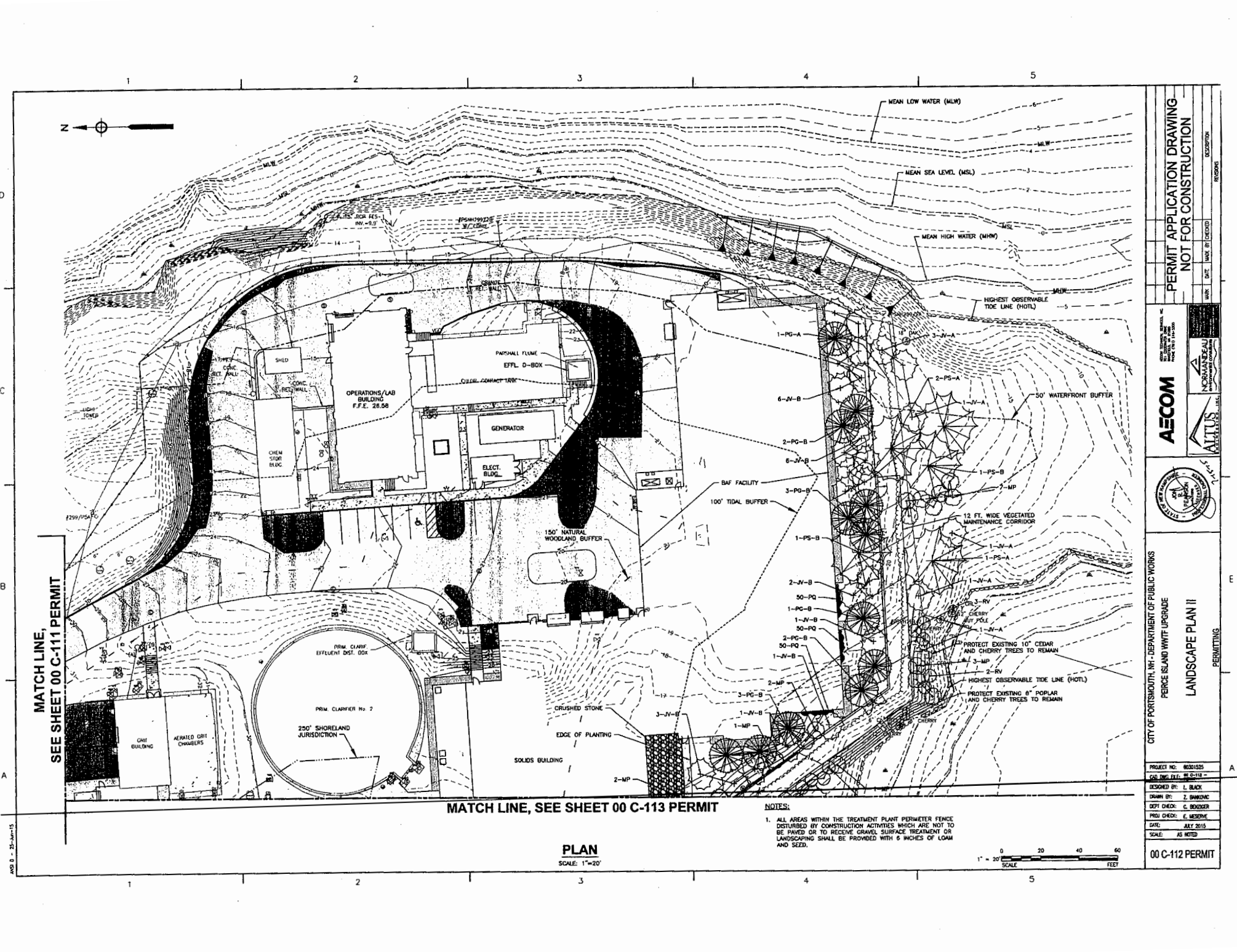

MATCH LINE, SEE SHEET 00 C-111 PERMIT

MATCH LINE, SEE SHEET 00 C-113 PERMIT

PLAN
SCALE: 1"=20'

NOTES:

1. ALL AREAS WITHIN THE TREATMENT PLANT PERIMETER FENCE DISTURBED BY CONSTRUCTION ACTIVITIES WHICH ARE NOT TO BE PAVED OR TO RECEIVE GRAVEL SURFACE TREATMENT OR LANDSCAPING SHALL BE PROVIDED WITH 6 INCHES OF LOAM AND SEED.

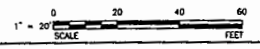

| | |
|---|---|
| <p>PERMIT APPLICATION DRAWING NOT FOR CONSTRUCTION</p> <p>DATE: _____ DATE DRAWN BY: _____</p> | <p>PROJECT NO: 00301525 JOB: WWT UPGRADE - PERCE ISLAND WWT DESIGNED BY: L. BLACK DRAWN BY: Z. BANWANG DEPT CHECK: C. BOEDIGER PROJ CHECK: E. MESSIERE DATE: JULY 2015 SCALE: AS NOTED</p> |
| <p>AECOM</p> <p>1000 EAST 17TH AVENUE DENVER, CO 80202</p> | <p>NORMANDEAU</p> <p>1000 EAST 17TH AVENUE DENVER, CO 80202</p> |
| <p>ALTUS</p> <p>1000 EAST 17TH AVENUE DENVER, CO 80202</p> | <p>CITY OF PORTSMOUTH, NH - DEPARTMENT OF PUBLIC WORKS</p> <p>PERCE ISLAND WWT UPGRADE</p> <p>LANDSCAPE PLAN II</p> <p>PERMITTING</p> |
| <p>00 C-112 PERMIT</p> | |

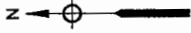

MATCH LINE, SEE SHEET 00 C-112 PERMIT

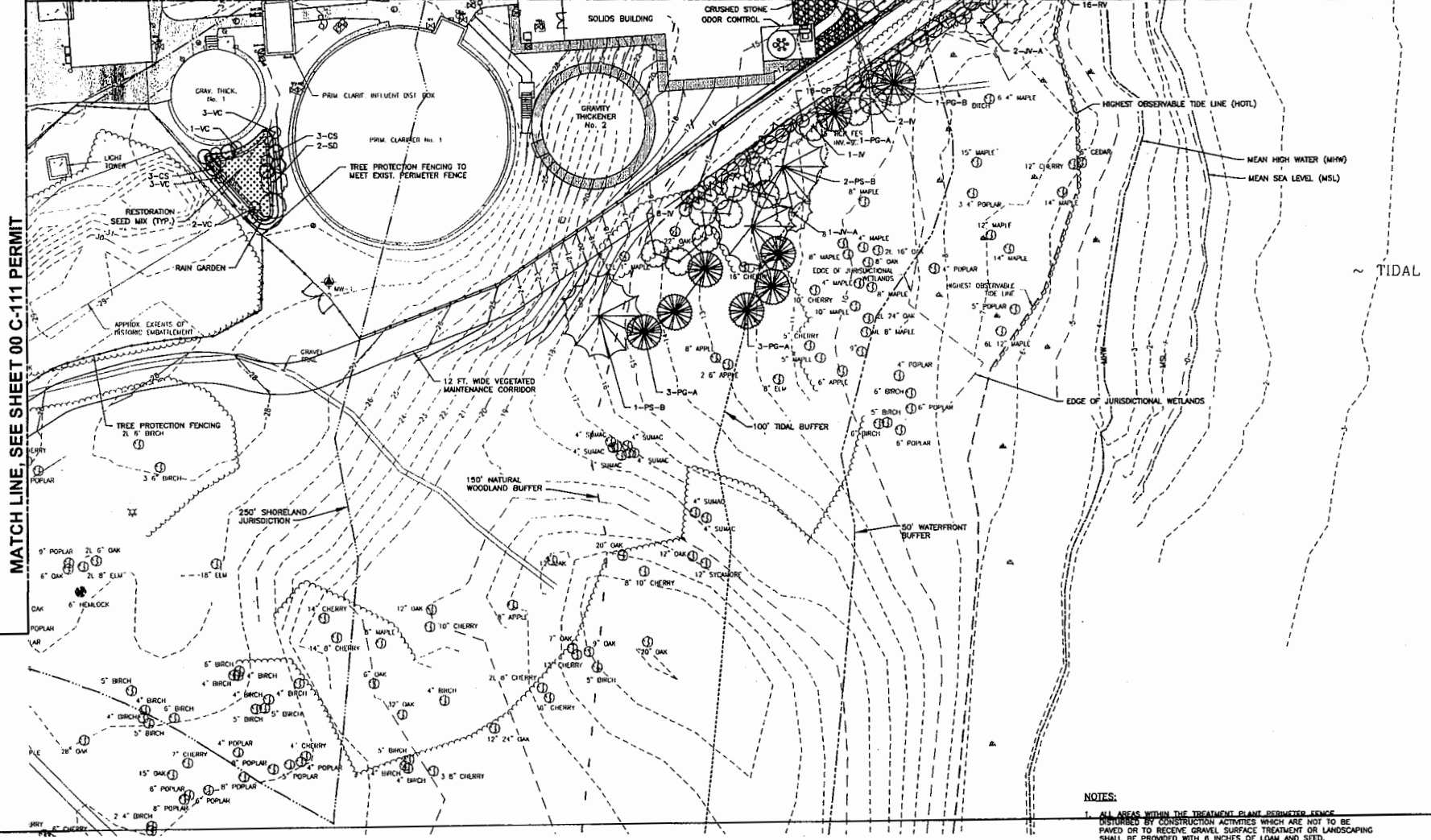

PLAN
SCALE: 1"=20'

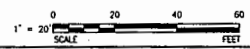

NOTES:
 1. ALL AREAS WITHIN THE TREATMENT PLANT PERIMETER FENCE DISTURBED BY CONSTRUCTION ACTIVITIES WHICH ARE NOT TO BE PAVED OR TO RECEIVE GRAVEL SURFACE TREATMENT OR LANDSCAPING SHALL BE PROVIDED WITH 6 INCHES OF LOAM AND SEED.

MATCH LINE, SEE SHEET 00 C-111 PERMIT

PERMIT APPLICATION DRAWING
 NOT FOR CONSTRUCTION

AECOM
 CONSULTANTS INC.

ALTUS
 RESTORATION INC.

NORMANEAU
 CONSULTANTS INC.

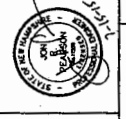

CITY OF PORTSMOUTH, NH - DEPARTMENT OF PUBLIC WORKS
 PERICE ISLAND WWWT UPGRADE
 LANDSCAPE PLAN III
 PERMITTING

PROJECT NO: 0001030
 CAD DWG FILE: 00 C-113 -
 DRAWN BY: J. SHAWMAY
 XREF CHECK: C. BRIDGER
 PROJ CHECK: E. HERRING
 DATE: JULY 2015
 SCALE: AS NOTED

00 C-113 PERMIT

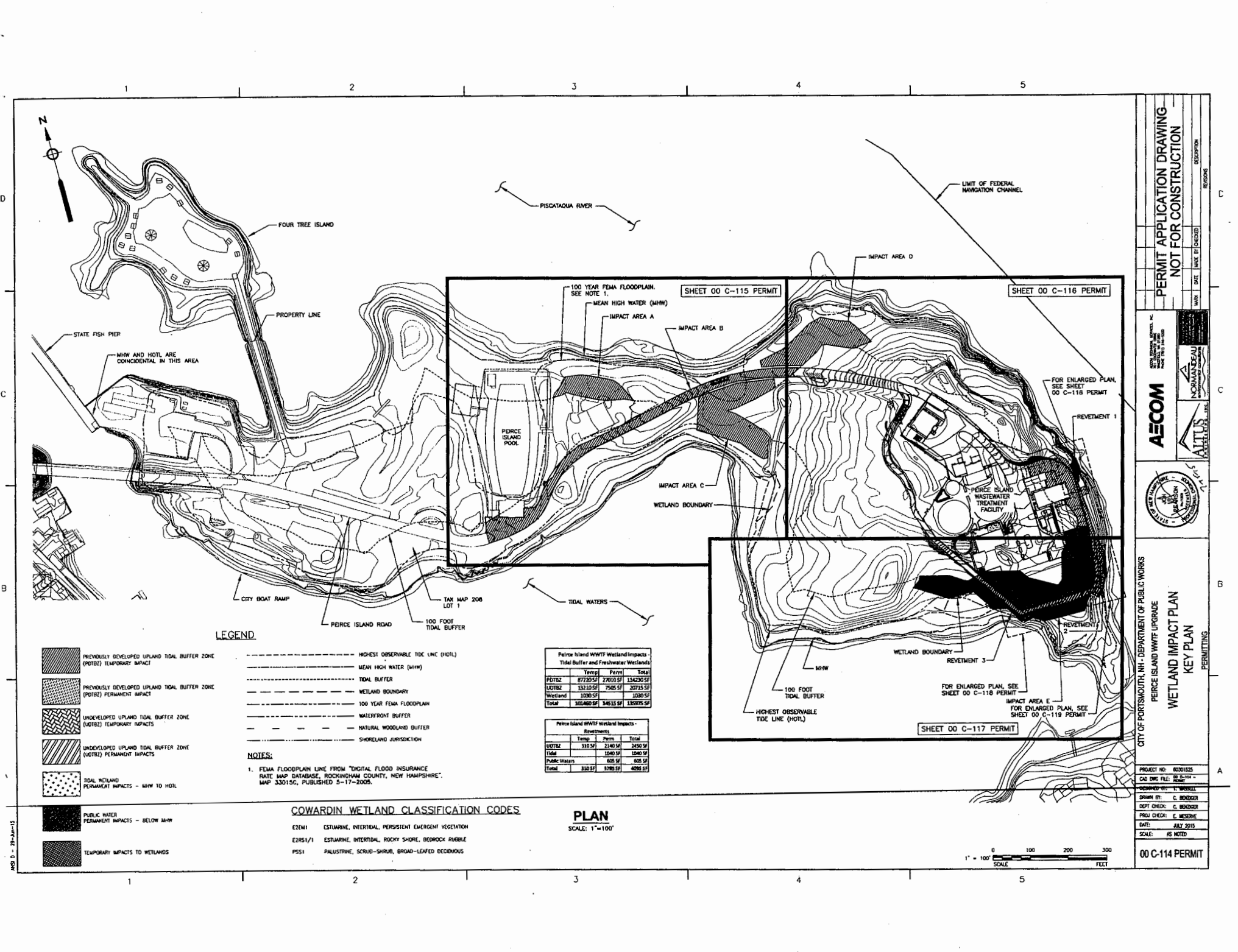

LEGEND

- PREVIOUSLY DEVELOPED UPLAND TIDAL BUFFER ZONE (PDTBZ) TEMPORARY IMPACT
- PREVIOUSLY DEVELOPED UPLAND TIDAL BUFFER ZONE (PDTBZ) PERMANENT IMPACT
- UNDEVELOPED UPLAND TIDAL BUFFER ZONE (UDTDBZ) TEMPORARY IMPACTS
- UNDEVELOPED UPLAND TIDAL BUFFER ZONE (UDTDBZ) PERMANENT IMPACTS
- TIDAL WETLAND PERMANENT IMPACTS - MHW TO HOTL
- PUBLIC WATER PERMANENT IMPACTS - BELOW MHW
- TEMPORARY IMPACTS TO WETLANDS
- HIGHEST OBSERVABLE TIDE LINE (HOTL)
- MEAN HIGH WATER (MHW)
- TIDAL BUFFER
- WETLAND BOUNDARY
- 100 YEAR FEMA FLOODPLAIN
- WATERFRONT BUFFER
- NATURAL WOODLAND BUFFER
- SHORELAND JURISDICTION

NOTES:
 1. FEMA FLOODPLAIN LINE FROM "DIGITAL FLOOD INSURANCE RATE MAP DATABASE, ROCKINGHAM COUNTY, NEW HAMPSHIRE", MAP 33015C, PUBLISHED 5-17-2005.

| | Temp | Perm | Total |
|--------------|------------------|-----------------|------------------|
| PDTBZ | 87720 SF | 27610 SF | 115330 SF |
| UDTDBZ | 13310 SF | 7505 SF | 20815 SF |
| Wetland | 1000 SF | | 1000 SF |
| Total | 102030 SF | 34615 SF | 136645 SF |

| | Temp | Perm | Total |
|---------------|---------------|----------------|----------------|
| UDTDBZ | 310 SF | 2140 SF | 2450 SF |
| Tidal | | 1040 SF | 1040 SF |
| Public Waters | 620 SF | | 620 SF |
| Total | 930 SF | 3180 SF | 4110 SF |

COWARDIN WETLAND CLASSIFICATION CODES

- E2M1 ESTUARINE, INTERTIDAL, PERSISTENT EMERGENT VEGETATION
- E2R1/1 ESTUARINE, INTERTIDAL, ROCKY SHORE, BEDROCK RUBBLE
- PSS1 PALUSTRINE, SCRUB-SHRUB, BROAD-LEAFED DECIDUOUS

PLAN
SCALE: 1"=100'

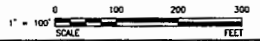

PERMIT APPLICATION DRAWING
NOT FOR CONSTRUCTION

AECOM

CONSTRUCTION SERVICES
 1000 WATER STREET
 PORTSMOUTH, NH 03801
 TEL: 603.886.1000
 FAX: 603.886.1001
 WWW.AECOM.COM

NON-CONSTRUCTION SERVICES
 1000 WATER STREET
 PORTSMOUTH, NH 03801
 TEL: 603.886.1000
 FAX: 603.886.1001
 WWW.AECOM.COM



WETLAND IMPACT PLAN
KEY PLAN

CITY OF PORTSMOUTH, NH - DEPARTMENT OF PUBLIC WORKS
 PEIRCE ISLAND WWTF UPGRADE

00 C-114 PERMIT

| | |
|---------------|------------|
| PROJECT NO: | 6001025 |
| CAD DWG FILE: | 00-114 |
| DRAWN BY: | E. BRIDGES |
| CHECKED BY: | C. BRIDGES |
| DATE: | AUG 2010 |
| SCALE: | AS NOTED |

ANS D - 31-AM-15

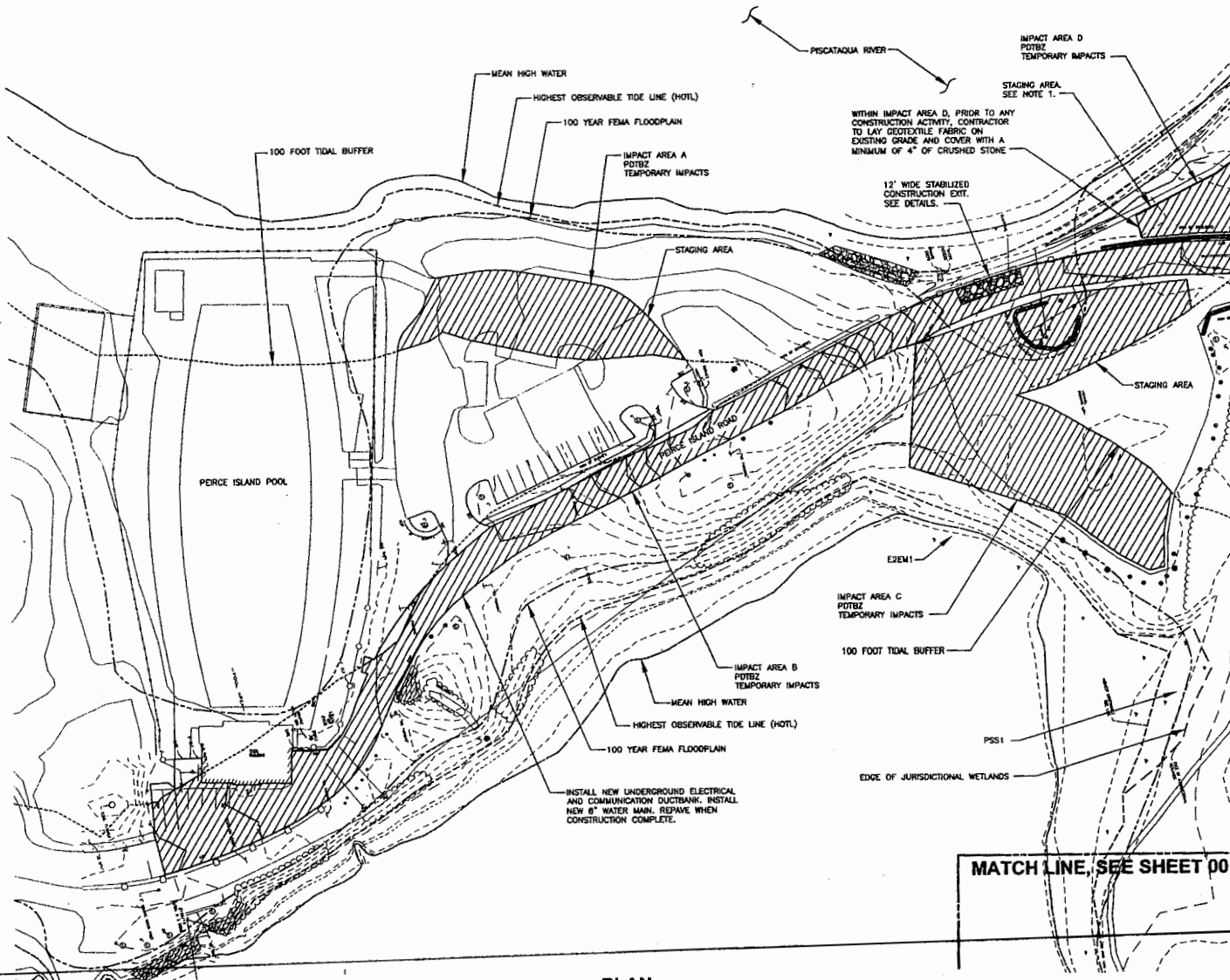

MATCH LINE, SEE SHEET 00 C-116 PERMIT

MATCH LINE, SEE SHEET 00 C-117 PERMIT

PLAN
SCALE: 1"=40'

NOTES:

1. AT THE CONCLUSION OF CONSTRUCTION ACTIVITIES, CONTRACTOR TO SCARIFY TOP 4" OF EXISTING SOIL IN THE STAGING AREAS AND TOP WITH 2" OF COMPOSTED LOAM AND SEED.

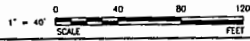

| <p>PERMIT APPLICATION DRAWING NOT FOR CONSTRUCTION</p> | <p>REVISIONS</p> <table border="1" style="width: 100%; border-collapse: collapse;"> <tr> <th>NO.</th> <th>DATE</th> <th>BY</th> <th>DESCRIPTION</th> </tr> <tr> <td> </td> <td> </td> <td> </td> <td> </td> </tr> </table> | NO. | DATE | BY | DESCRIPTION | | | | |
|--|--|-----|-------------|----|-------------|--|--|--|--|
| NO. | DATE | BY | DESCRIPTION | | | | | | |
| | | | | | | | | | |
| <p>AECOM</p> <p>100 WATER STREET, SUITE 200 PORTSMOUTH, NH 03801 TEL: 603.886.1000 WWW.AECOM.COM</p> | | | | | | | | | |
| <p>AITTUS</p> <p>100 WATER STREET, SUITE 200 PORTSMOUTH, NH 03801 TEL: 603.886.1000 WWW.AITTUS.COM</p> | | | | | | | | | |
| | | | | | | | | | |
| <p>CITY OF PORTSMOUTH, NH - DEPARTMENT OF PUBLIC WORKS PERCE ISLAND WWTF UPGRADE WETLAND IMPACT PLAN I</p> <p style="text-align: right;">PERMITTING</p> | | | | | | | | | |
| <p>PROJECT NO: 0001152</p> <p>DRAWING TITLE: PERMIT</p> <p>DRAWN BY: T. WASSILL</p> <p>SEPT CHECK: C. BISHOP</p> <p>PREL CHECK: L. MESSING</p> <p>DATE: JULY 2015</p> <p>SCALE: AS NOTED</p> <p>00 C-115 PERMIT</p> | | | | | | | | | |

1 2 3 4 5



MATCH LINE, SEE SHEET 00 C-115 PERMIT

MATCH LINE, SEE SHEET 00 C-116 PERMIT

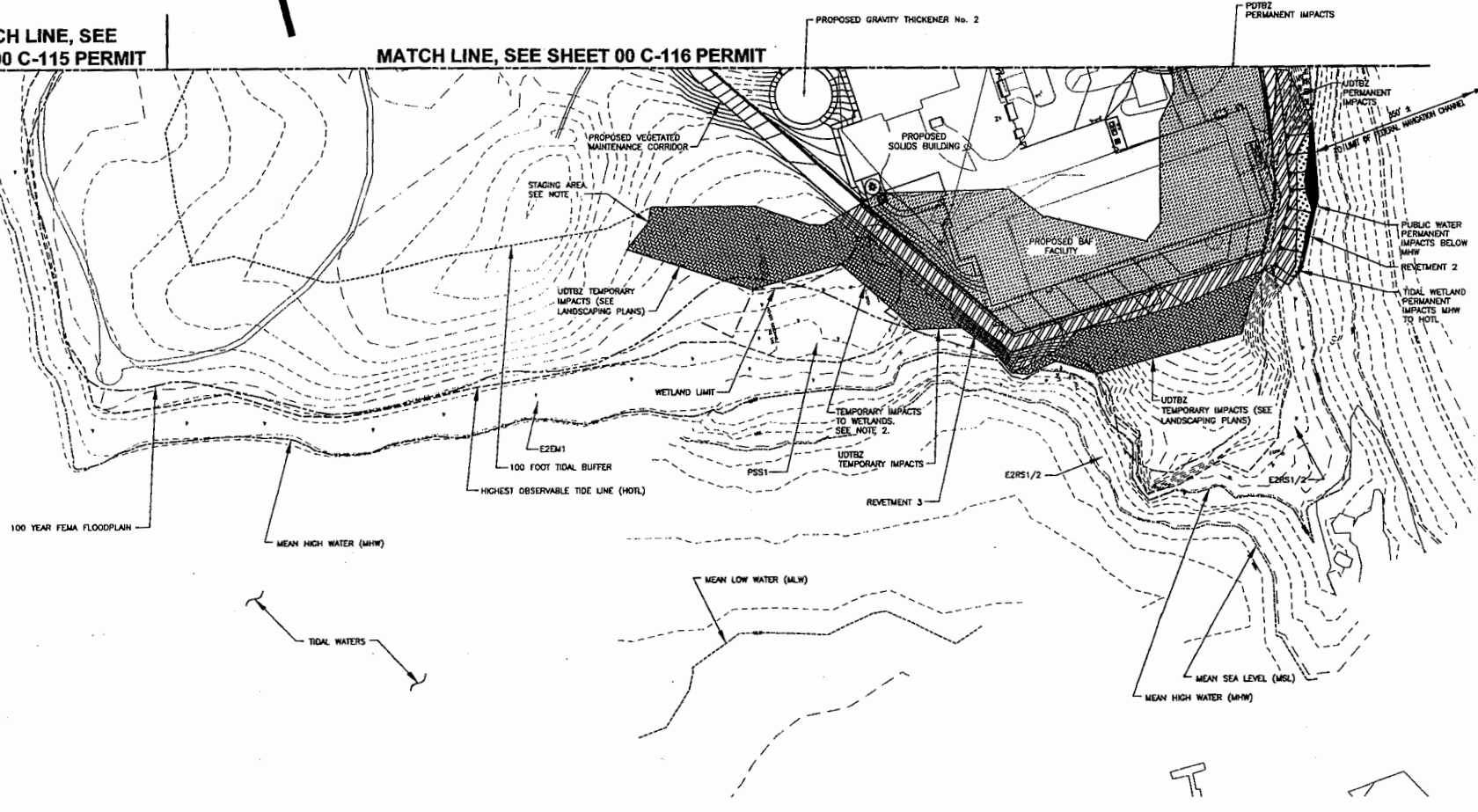

PLAN
SCALE: 1"=40'

NOTES:

1. AT THE CONCLUSION OF CONSTRUCTION ACTIVITIES, CONTRACTOR TO SCARP TOP 4" OF EXISTING SOIL IN THE STAGING AREAS AND TOP WITH 2" OF COMPOSTED LOAM AND SEED.
2. PRIOR TO ANY CONSTRUCTION ACTIVITY, CONTRACTOR TO LAY GEOTEXTILE FABRIC ON EXISTING GRADE AND COVER WITH A MINIMUM OF 4" OF CRUSHED STONE.

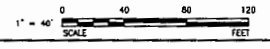

| | |
|--|-------------|
| PERMIT APPLICATION DRAWING NOT FOR CONSTRUCTION | |
| NO. 0001525 | DESCRIPTION |
| CAD FILE: 00 C-117 | REVISIONS |
| DESIGNED BY: I. WISSELL | DATE |
| DRAWN BY: C. BOEDER | DATE |
| DEPT CHECK: C. BOEDER | DATE |
| PROJ CHECK: E. WESERVE | DATE |
| DATE: JULY 2015 | DATE |
| SCALE: AS NOTED | DATE |
| 00 C-117 PERMIT | |

CITY OF PORTSMOUTH, NH - DEPARTMENT OF PUBLIC WORKS
PERCE ISLAND WWTF UPGRADE

WETLAND IMPACT PLAN III

PERMITTING

AECOM
CORPORATE OFFICE
100 WATER STREET
PORTSMOUTH, NH 02870
TEL: 603.886.1000
WWW.AECOM.COM

ALTUS
WETLAND SERVICES
100 WATER STREET
PORTSMOUTH, NH 02870
TEL: 603.886.1000
WWW.ALTUSWETLANDS.COM

000 B - 25 July 2015

1 2 3 4 5

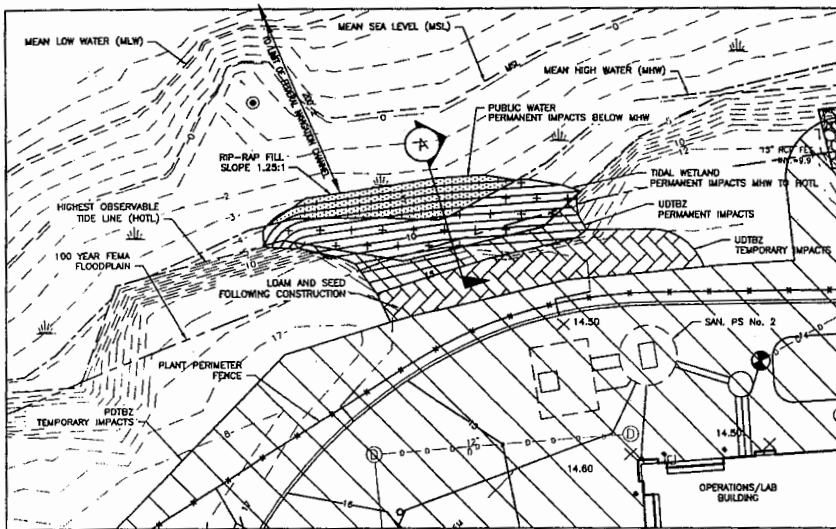

REVETMENT 1 PLAN

SCALE: 1"=10'

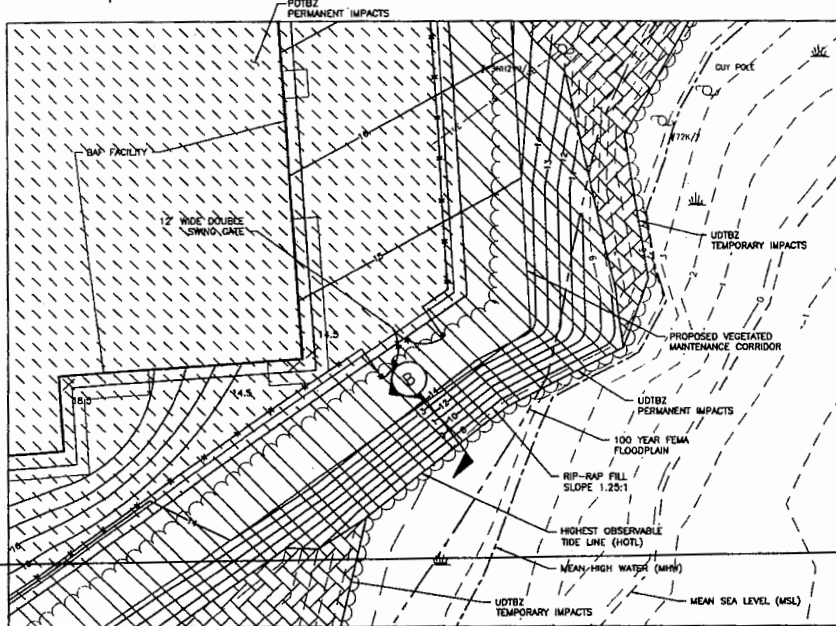
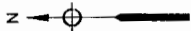

REVETMENT 3 PLAN

SCALE: 1"=10'

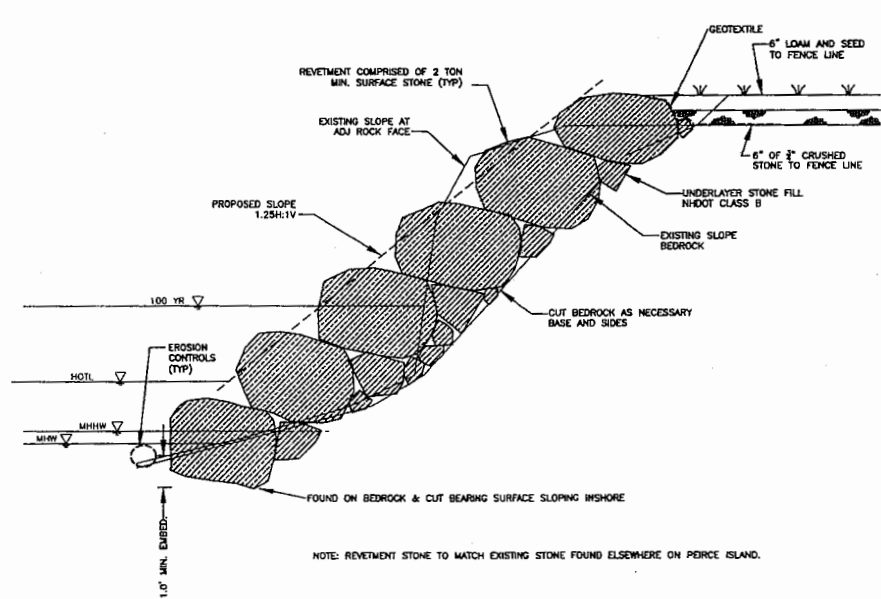

SECTION A

SCALE: 1"=2'

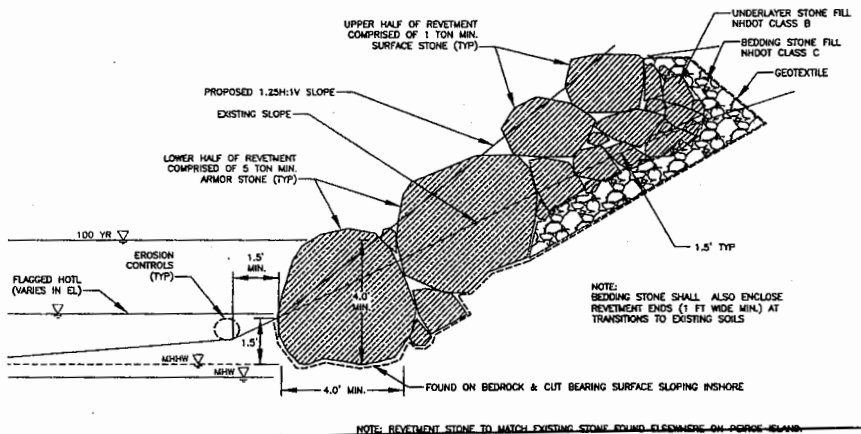

SECTION B

SCALE: 1"=2'

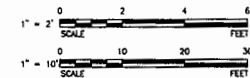

PERMIT APPLICATION DRAWING - NOT FOR CONSTRUCTION
 AECOM
 NORWAM SDEAL
 AITUS
 CITY OF PORTSMOUTH, NH - DEPARTMENT OF PUBLIC WORKS
 PERCE ISLAND WHFV UPGRADE
 ENLARGED PLANS AND SECTIONS
 REVETMENT AREAS I
 PROJECT NO. 00C-118
 CIVIL ENGINEERING - PERCE ISLAND
 DESIGNED BY: M. ROSSER
 DRAWN BY: S. WOODRUFF
 CHECKED BY: S. WOODRUFF
 PROJ. CHECK: E. WESSELY
 DATE: JULY 2015
 SCALE: AS NOTED
 00 C-118 PERMIT

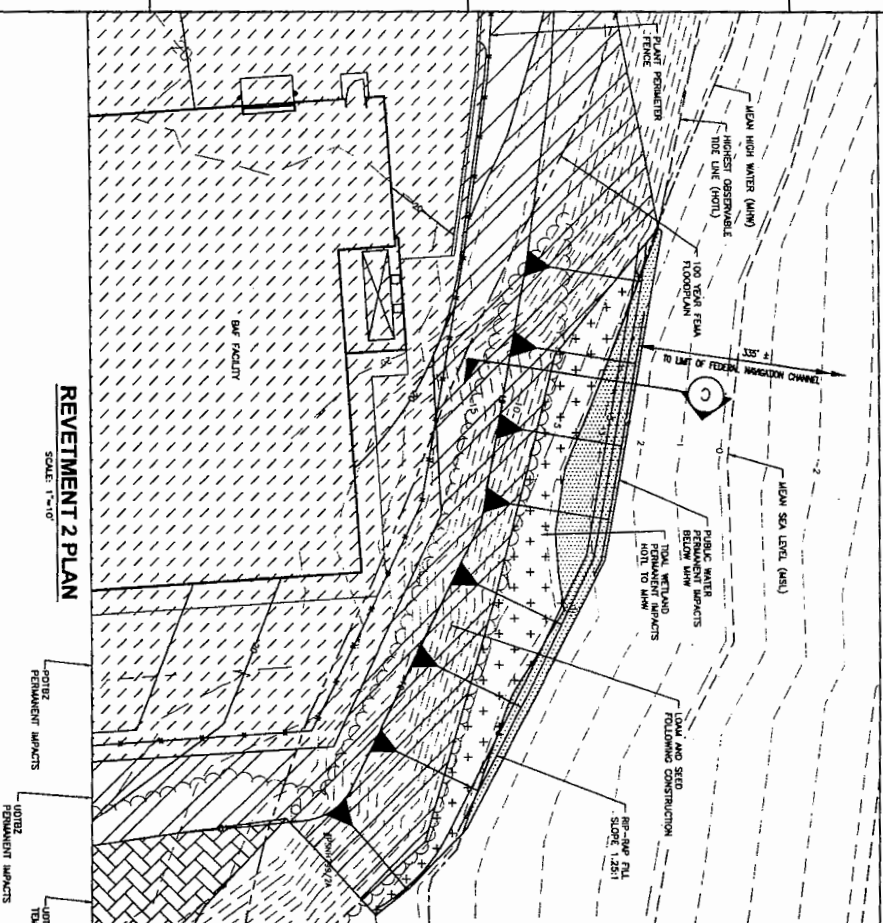

REVETMENT 2 PLAN
SCALE: 1"=10'

SMALL PERMANENT IMPACTS
LARGE TEMPORARY IMPACTS
LARGE PERMANENT IMPACTS

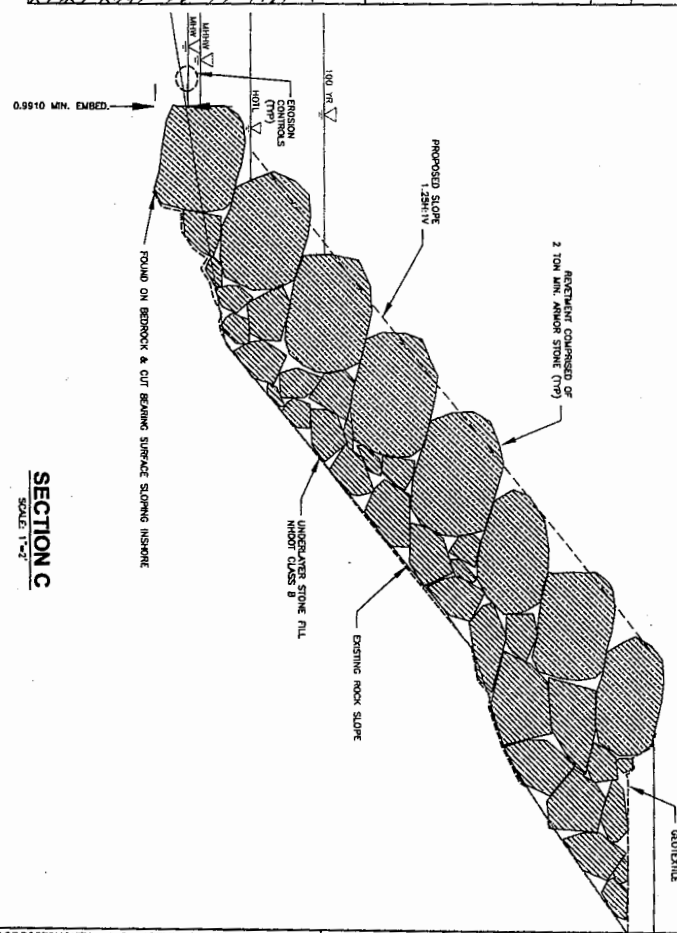

SECTION C
SCALE: 1"=2'

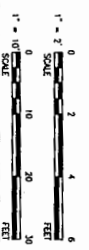

| | |
|-------------|-----------------|
| PROJECT NO. | 00-C-119 PERMIT |
| DATE | JULY 2015 |
| SCALE | AS SHOWN |
| DESIGNED BY | L. WOODILL |
| DRAWN BY | C. BORDOZZO |
| CHECKED BY | C. BORDOZZO |
| IN CHARGE | E. MORGAN |

CITY OF PORTSMOUTH, NH - DEPARTMENT OF PUBLIC WORKS
 PEIRCE ISLAND WWTF UPGRADE
**ENLARGED PLAN AND SECTION
 REVETMENT AREAS II**
 PERMITTING

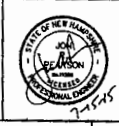

AECOM
 600 SOUTH GERRARD ST. #100
 ANN ARBOR MI 48106-1000
 TEL: 734.769.7000
 FAX: 734.769.7001
 WWW.AECOM.COM

ALTUS
 ENGINEERS, INC.

NORMANDEAU
 ENVIRONMENTAL CONSULTANTS

| | | | |
|--|------|-------------------|-------------|
| PERMIT APPLICATION DRAWING NOT FOR CONSTRUCTION | | | |
| MARK | DATE | MADE BY (CHECKED) | DESCRIPTION |
| | | | |
| | | | |

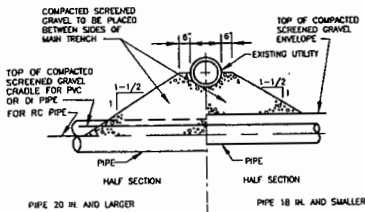

TYPE A

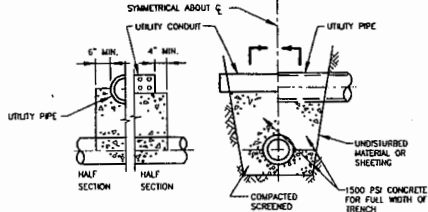

TYPE C

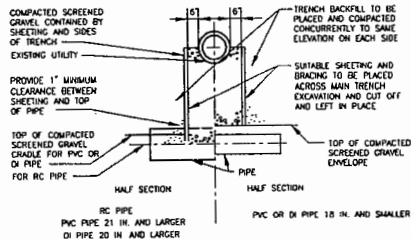

TYPE B

TYPICAL SUPPORTS FOR UTILITIES

NOT TO SCALE
2-1.8 (REV. 03-15-95)

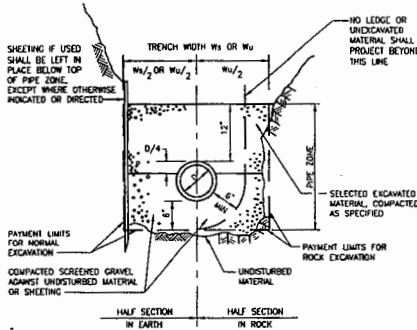

TRENCH SECTION FOR DI OR PVC PIPE 20 INCH DIAMETER AND LARGER

NOT TO SCALE
2-1.1.2 (REV. 03-15-95)

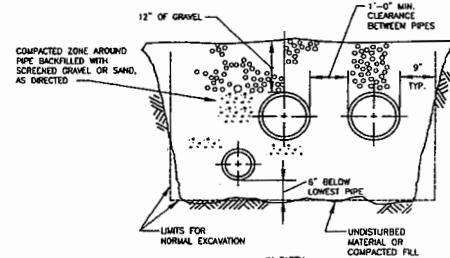

MULTIPLE PIPE TRENCH SECTION

NOT TO SCALE

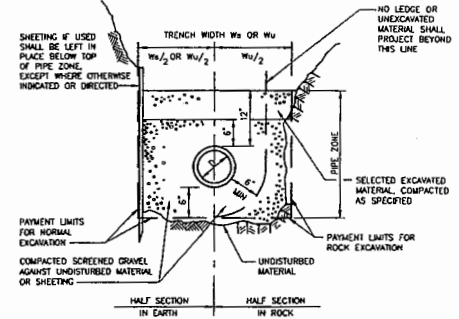

TRENCH SECTION FOR PIPE 18 INCH DIAMETER AND SMALLER

NOT TO SCALE

| TRENCH WIDTH W_s OR W_u | |
|-----------------------------|---|
| NOMINAL PIPE DIAMETER D | DEPTH OF PIPE INVERT BELOW GROUND SURFACE |
| | 0 TO 12' |
| | 12' TO 20' |
| | >20' |
| 24" AND SMALLER | 5'-0" 7'-0" 8'-0" |
| OVER 24" | D + 3'-0" D + 5'-0" D + 7'-0" |

- PIPE TRENCHES MAY BE EXCAVATED WIDER THAN TRENCH WIDTH W_s (SHEETED) OR W_u (UNSHEETED) ABOVE THE TOP OF PIPE ZONE.
- TRENCHES SHALL NOT BE EXCAVATED BEYOND THE TRENCH WIDTH W_u BELOW THE TOP OF PIPE ZONE.
- SHEETING MUST BE USED IF EXCAVATION AND BACKFILL BELOW NORMAL DEPTH IS REQUIRED. SHEETING SHALL BE LEFT IN PLACE BELOW A LINE 1'-0" ABOVE THE TOP OF PIPE.

GENERAL NOTES FOR PIPE TRENCHES

NOT TO SCALE
2-1.1.11 (REV. 10-23-95)

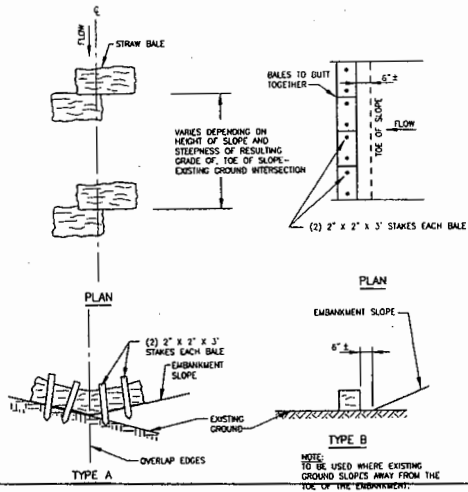

STRAW BALE EROSION CONTROL

NIS
2-1.60.4 (REV. 09-29-95)

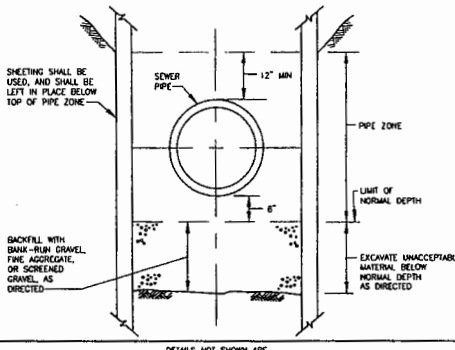

TRENCH SECTION IN UNACCEPTABLE MATERIAL

NOT TO SCALE
2-1.1.21 (REV. 03-15-95)

PERMIT APPLICATION DRAWING
 NOT FOR CONSTRUCTION

AECOM
 100 WATER STREET, SUITE 200
 PORTSMOUTH, NH 02870
 TEL: 603.271.1000
 FAX: 603.271.1001
 WWW.AECOM.COM

ALTUS
 100 WATER STREET, SUITE 200
 PORTSMOUTH, NH 02870
 TEL: 603.271.1000
 FAX: 603.271.1001
 WWW.ALTUS.COM

CITY OF PORTSMOUTH, NH - DEPARTMENT OF PUBLIC WORKS
 PEIRCE ISLAND WWTF UPGRADE

DETAILS I
 PERMITTING

PROJECT NO: 00301523
 CAD DWG FILE: 00-0-100-PRM01
 DRAWN BY: N. YEE
 DATE CHECKED: C. BOZDOR
 PROJ CHECKED: E. MESSINE
 DATE: JULY 2015
 SCALE: AS NOTED

00 C-120 PERMIT

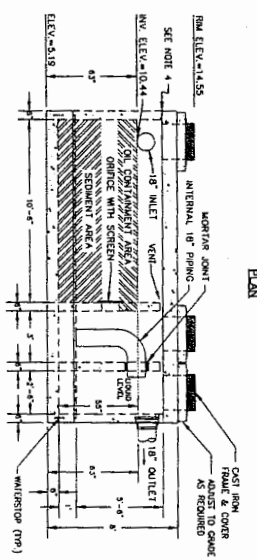
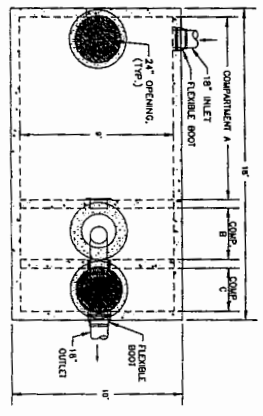

GENERAL NOTES

1. WQI SHALL BE PROVIDED BY PIPING PRECAST PRODUCTS, CONCORD, NH, A 3,000 GALLON 18" DIA. 3 COMP WATER QUALITY UNIT, OPTION 3 OR APPROVAL EQUAL.
2. SECTIONS FOR PRECAST INLET COMPONENTS TO VATEST AS PER SPECIFICATIONS: ASM-4815 GRADE 60 BLACK DEFORMED BARS.
3. DESIGN SPECIFIED AS OF 18-08, A4510-1892.
4. BUTYL RUBBER JOINT SEALANT SHALL BE USED AT ALL JOINTS.

5,000 GALLON WATER QUALITY INLET (WQI) STRUCTURE
NOT TO SCALE

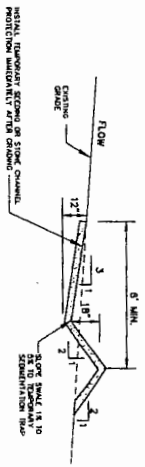

MAINTENANCE

1. THE FOUNDATION AREA OF THE DIVERSION SHALL BE CLEANED AND GRADED OF ALL TRUCKS.
2. MATERIALS REQUIRED FROM THE FOUNDATION SHALL BE EXPOSED OF 50 HFT MAX. NOT TO EXCEED 100 HFT.
3. THE DIVERSION SHALL BE EXPOSED TO 100 HFT MAX. NOT TO EXCEED 150 HFT.
4. THE DIVERSION SHALL BE EXPOSED TO 100 HFT MAX. NOT TO EXCEED 150 HFT.
5. THE DIVERSION SHALL BE EXPOSED TO 100 HFT MAX. NOT TO EXCEED 150 HFT.
6. THE DIVERSION SHALL BE EXPOSED TO 100 HFT MAX. NOT TO EXCEED 150 HFT.
7. THE DIVERSION SHALL BE EXPOSED TO 100 HFT MAX. NOT TO EXCEED 150 HFT.
8. THE DIVERSION SHALL BE EXPOSED TO 100 HFT MAX. NOT TO EXCEED 150 HFT.

CONSTRUCTION SPECIFICATIONS

1. THE FOUNDATION AREA OF THE DIVERSION SHALL BE CLEANED AND GRADED OF ALL TRUCKS.

2. MATERIALS REQUIRED FROM THE FOUNDATION SHALL BE EXPOSED OF 50 HFT MAX. NOT TO EXCEED 100 HFT.

3. THE DIVERSION SHALL BE EXPOSED TO 100 HFT MAX. NOT TO EXCEED 150 HFT.

4. THE DIVERSION SHALL BE EXPOSED TO 100 HFT MAX. NOT TO EXCEED 150 HFT.

5. THE DIVERSION SHALL BE EXPOSED TO 100 HFT MAX. NOT TO EXCEED 150 HFT.

6. THE DIVERSION SHALL BE EXPOSED TO 100 HFT MAX. NOT TO EXCEED 150 HFT.

7. THE DIVERSION SHALL BE EXPOSED TO 100 HFT MAX. NOT TO EXCEED 150 HFT.

8. THE DIVERSION SHALL BE EXPOSED TO 100 HFT MAX. NOT TO EXCEED 150 HFT.

TEMPORARY DIVERSION SWALE
NOT TO SCALE

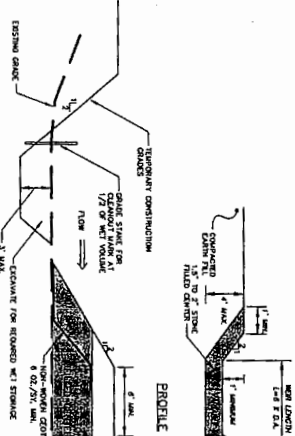

TEMPORARY SEDIMENT TRAP (TSD) OUTLET
NOT TO SCALE

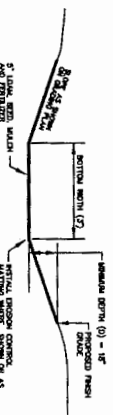

MAINTENANCE

1. SWALE SHALL BE PROVIDED AND THE TRAP SHALL BE DESIGNED TO ITS ORIGINAL CAPACITY.
2. THE SWALE SHALL BE MAINTAINED TO 1/2 THE DESIGN SET POINT. MATERIALS SHALL BE EXPOSED TO 100 HFT MAX. NOT TO EXCEED 150 HFT.
3. THE SWALE SHALL BE MAINTAINED TO 1/2 THE DESIGN SET POINT. MATERIALS SHALL BE EXPOSED TO 100 HFT MAX. NOT TO EXCEED 150 HFT.
4. THE SWALE SHALL BE MAINTAINED TO 1/2 THE DESIGN SET POINT. MATERIALS SHALL BE EXPOSED TO 100 HFT MAX. NOT TO EXCEED 150 HFT.
5. THE SWALE SHALL BE MAINTAINED TO 1/2 THE DESIGN SET POINT. MATERIALS SHALL BE EXPOSED TO 100 HFT MAX. NOT TO EXCEED 150 HFT.
6. THE SWALE SHALL BE MAINTAINED TO 1/2 THE DESIGN SET POINT. MATERIALS SHALL BE EXPOSED TO 100 HFT MAX. NOT TO EXCEED 150 HFT.
7. THE SWALE SHALL BE MAINTAINED TO 1/2 THE DESIGN SET POINT. MATERIALS SHALL BE EXPOSED TO 100 HFT MAX. NOT TO EXCEED 150 HFT.
8. THE SWALE SHALL BE MAINTAINED TO 1/2 THE DESIGN SET POINT. MATERIALS SHALL BE EXPOSED TO 100 HFT MAX. NOT TO EXCEED 150 HFT.

CONSTRUCTION SPECIFICATIONS

1. THE FOUNDATION AREA OF THE DIVERSION SHALL BE CLEANED AND GRADED OF ALL TRUCKS.

2. MATERIALS REQUIRED FROM THE FOUNDATION SHALL BE EXPOSED OF 50 HFT MAX. NOT TO EXCEED 100 HFT.

3. THE DIVERSION SHALL BE EXPOSED TO 100 HFT MAX. NOT TO EXCEED 150 HFT.

4. THE DIVERSION SHALL BE EXPOSED TO 100 HFT MAX. NOT TO EXCEED 150 HFT.

5. THE DIVERSION SHALL BE EXPOSED TO 100 HFT MAX. NOT TO EXCEED 150 HFT.

6. THE DIVERSION SHALL BE EXPOSED TO 100 HFT MAX. NOT TO EXCEED 150 HFT.

7. THE DIVERSION SHALL BE EXPOSED TO 100 HFT MAX. NOT TO EXCEED 150 HFT.

8. THE DIVERSION SHALL BE EXPOSED TO 100 HFT MAX. NOT TO EXCEED 150 HFT.

GRASSED SWALE
NOT TO SCALE

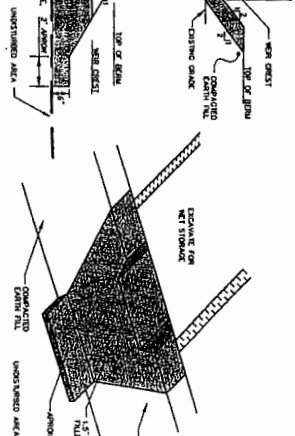

MAINTENANCE

1. SWALE SHALL BE PROVIDED AND THE TRAP SHALL BE DESIGNED TO ITS ORIGINAL CAPACITY.
2. THE SWALE SHALL BE MAINTAINED TO 1/2 THE DESIGN SET POINT. MATERIALS SHALL BE EXPOSED TO 100 HFT MAX. NOT TO EXCEED 150 HFT.
3. THE SWALE SHALL BE MAINTAINED TO 1/2 THE DESIGN SET POINT. MATERIALS SHALL BE EXPOSED TO 100 HFT MAX. NOT TO EXCEED 150 HFT.
4. THE SWALE SHALL BE MAINTAINED TO 1/2 THE DESIGN SET POINT. MATERIALS SHALL BE EXPOSED TO 100 HFT MAX. NOT TO EXCEED 150 HFT.
5. THE SWALE SHALL BE MAINTAINED TO 1/2 THE DESIGN SET POINT. MATERIALS SHALL BE EXPOSED TO 100 HFT MAX. NOT TO EXCEED 150 HFT.
6. THE SWALE SHALL BE MAINTAINED TO 1/2 THE DESIGN SET POINT. MATERIALS SHALL BE EXPOSED TO 100 HFT MAX. NOT TO EXCEED 150 HFT.
7. THE SWALE SHALL BE MAINTAINED TO 1/2 THE DESIGN SET POINT. MATERIALS SHALL BE EXPOSED TO 100 HFT MAX. NOT TO EXCEED 150 HFT.
8. THE SWALE SHALL BE MAINTAINED TO 1/2 THE DESIGN SET POINT. MATERIALS SHALL BE EXPOSED TO 100 HFT MAX. NOT TO EXCEED 150 HFT.

CONSTRUCTION SPECIFICATIONS

1. THE FOUNDATION AREA OF THE DIVERSION SHALL BE CLEANED AND GRADED OF ALL TRUCKS.

2. MATERIALS REQUIRED FROM THE FOUNDATION SHALL BE EXPOSED OF 50 HFT MAX. NOT TO EXCEED 100 HFT.

3. THE DIVERSION SHALL BE EXPOSED TO 100 HFT MAX. NOT TO EXCEED 150 HFT.

4. THE DIVERSION SHALL BE EXPOSED TO 100 HFT MAX. NOT TO EXCEED 150 HFT.

5. THE DIVERSION SHALL BE EXPOSED TO 100 HFT MAX. NOT TO EXCEED 150 HFT.

6. THE DIVERSION SHALL BE EXPOSED TO 100 HFT MAX. NOT TO EXCEED 150 HFT.

7. THE DIVERSION SHALL BE EXPOSED TO 100 HFT MAX. NOT TO EXCEED 150 HFT.

8. THE DIVERSION SHALL BE EXPOSED TO 100 HFT MAX. NOT TO EXCEED 150 HFT.

STONE CHECK DAM DETAIL
NOT TO SCALE

| | | | | |
|---|--|--|--|--|
| CITY OF PORTSMOUTH, NH - DEPARTMENT OF PUBLIC WORKS | | | PERMIT APPLICATION DRAWING NOT FOR CONSTRUCTION | |
| PEIRCE ISLAND WWTF UPGRADE | | | | |
| DETAILS VIII | | | | PROJECT NO. 00-C-127 PERMIT SHEET NO. 11 OF 11 DATE: MAY 2011 SCALE: AS SHOWN |
| PERMITTING | | | | MARK DATE MADE BY CHECKED DESCRIPTION REVISIONS |



**US Army Corps
of Engineers** ®
New England District

(Minimum Notice: Permittee must sign and return notification
within one month of the completion of work.)

COMPLIANCE CERTIFICATION FORM

Permit Number: NAE-2015-01929

Project Manager Richard Kristoff

Name of Permittee: Portsmouth

Permit Issuance Date: November 23, 2015

Please sign this certification and return it to the following address upon completion of the activity and any mitigation required by the permit. You must submit this after the mitigation is complete, but not the mitigation monitoring, which requires separate submittals.

 * MAIL TO: U.S. Army Corps of Engineers, New England District *
 * Permits and Enforcement Branch C *
 * Regulatory Division *
 * 696 Virginia Road *
 * Concord, Massachusetts 01742-2751 *

Please note that your permitted activity is subject to a compliance inspection by an U.S. Army Corps of Engineers representative. If you fail to comply with this permit you are subject to permit suspension, modification, or revocation.

I hereby certify that the work authorized by the above referenced permit was completed in accordance with the terms and conditions of the above referenced permit, and any required mitigation was completed in accordance with the permit conditions.

Signature of Permittee

Date

Printed Name

Date of Work Completion

() _____
Telephone Number

() _____
Telephone Number